

CONDUIT SYSTEMS
FOR ELECTRICAL WIRES
AND CABLES



**TO
CONNECT
AND
PROTECT**

ANAMET Electrical, Inc. 
ANACONDA SEALTITE®



For over 100 years ANAMET has been the manufacturer and supplier of Anaconda Sealtite conduit systems and industrial metal hose solutions. Anamet is a world-wide producer of flexible electrical conduits as well as specialists in the field of flexible hoses for the transfer of fluids and gases.

ANAMET has a rich tradition of highly engineered, quality products used in applications ranging from machine tools, computer wiring, office furniture, power plants, nuclear power plants, petrochemical, naval, mass-transit, military shielding, and industrial construction. We supply flexible hose systems into steelworks, trains and transit systems, automotive, oil & gas, and food equipment as well as schools, hospitals and commercial buildings.

We continue to introduce new and innovative products to the market. Being a high-quality manufacturer, we meet or exceed the applicable UL, CSA, IEEE, and RoHS standards.

Located in Mattoon, Illinois, ANAMET Electrical, Inc. proudly manufactures over 80% of the product sold in USA within our own plant.

ANAMET, Inc. is a global company with manufacturing plants in the United States, Canada, and Europe. We are able to service and support our customers worldwide.

ANAMET Electrical, Inc. 
ANACONDA SEALTITE®

TABLE OF CONTENTS

NON-JACKETED FLEX SERIES	4
ALUMINUM FLEX RWA	5
STEEL FLEX RWS	6
STEEL FLEX DSL	7
STEEL FLEX DE-710	8
STAINLESS STEEL ULTRA-FLEX SL/UI CAP	9

METALLIC SEALTITE® SERIES	10
SEALTITE® UA	11
SEALTITE® CW-BLUE	12
SEALTITE® EFST	13
SEALTITE® EF	14
SEALTITE® OR	15
SEALTITE® MTC	16
SEALTITE® HC	17
SEALTITE® HTUA	18
SEALTITE® HCX	19
SEALTITE® HCSS	20
SEALTITE® XTHF	21
SEALTITE® EFL	22
SEALTITE® ZHUA	23
SEALTITE® HFSS	24
SEALTITE® SHIELDTITE	25
SEALTITE® SHIELDTITE Z1.....	26
SEALTITE® NWC	27
SEALTITE® FG	28
SEALTITE® FGSS	29
SEALTITE® FGUA	30

TABLE OF CONTENTS

SEALTITE® FITTINGS	31
FITTING SELECTION GUIDE	32
NICKEL PLATED BRASS PREMIUM NPT FITTINGS	33
NICKEL PLATED BRASS PREMIUM METRIC FITTINGS	34
STAINLESS STEEL AISI-304 PREMIUM NPT FITTINGS	35
STAINLESS STEEL AISI-316 PREMIUM NPT FITTINGS	36
ZINC-PLATED STEEL FITTINGS (STRAIGHT).....	37
ZINC-PLATED STEEL FITTINGS (ANGLED).....	38
CORD GRIPS AISI-316 / NICKEL PLATED BRASS	39
SPECIALTY SEALTITE® ATEX FITTINGS	40
STAINLESS STEEL ATEX AISI-316 NPT FITTINGS.....	41

NON-METALLIC SEALTITE® SERIES	42
SEALTITE® CNP (TYPE A) NON-METALLIC FLEXIBLE CONDUIT	43
STNM FITTINGS FOR CNP TYPE A CONDUIT (ONLY)	44
SEALTITE® NMUA (TYPE B) NON-METALLIC FLEXIBLE CONDUIT	45
SEALTITE® NMEF (TYPE B) NON-METALLIC FLEXIBLE TUBING	46
NON-METALLIC FITTINGS FOR NMUA/NMEF TYPE B ONLY	47

FIRETECH SERIES	48
FIRETECH SLEEVE	49
FIRETECH BLANKET	50
FIRETECH WRAP	51
FIRETECH TAPE	52

APPENDIX	53
CONDUIT CUTTING INSTRUCTIONS	54
CHEMICAL RESISTANCE	55
PRODUCT COMPARISON CHART	56



NON-JACKETED FLEX SERIES

ANAMET non-jacketed products are formed from metal strip of aluminum, galvanized steel or stainless steel. They are formed to meet the needs of the industry and, where applicable, meet the required approvals.

These conduits are for applications where protection against the elements is not required, such as inside an enclosure, or for indoor applications. These products are often used in OEM applications on equipment to protect wiring from damage.

ALUM-FLEX SERIES

ALUMINUM FLEX RWA NON-JACKETED FLEXIBLE CONDUIT

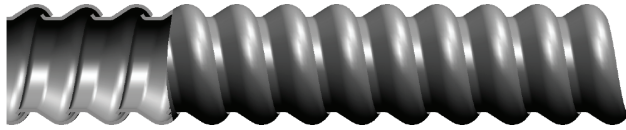

DESCRIPTION

- Non-jacketed aluminum flexible conduit
- Designed for commercial and industrial applications in the US market
- Available in custom cut lengths

NEC Articles

- 300.22 (C) Other spaces used for Environmental Air (Plenums)
- 250.102, 250.118(5) and 250.134(B) Equipment Grounding
- 348 Flexible Metal Conduit (FMC)
- 501.30(B) Class I Div. 2

SPECIFICATIONS:

- Aluminum strip-wound core, non-jacketed
- Temperature: +500°F (260°C) max.
- UL Approved #E98045
- NEMA 1 Enclosure

APPLICATIONS

- Commercial and industrial applications where liquid-tight protection is not required and UL approval is needed
- Permitted to be used in exposed and concealed locations (Article 348.10); enclosed motor leads (Article 430.245 (B)); elevators, escalators, wheelchair lifts (Article 620.21). Not for wet locations.



Modified S Profile 3/8" - 4"



Trade Size (mm)	Item ID	Std. Pkg. ft	Inside Diameter		Outside Diameter		Bend Radius	Weight lbs/cft
			Min	Max	Min	Max		
3/8" (12)	441503	100	0.375	0.393	0.560	0.610	2.0	7
	441504	1000						
1/2" (16)	441513	100	0.625	0.645	0.860	0.920	3.0	11
	441517	1000						
3/4" (21)	441523	100	0.812	0.835	1.045	1.105	4.0	14
	441526	500						
	441527	1000						
1" (27)	441532	50	1.000	1.040	1.300	1.380	5.0	22
	441533	300						
	441534	500						
1-1/4" (35)	441542	50	1.250	1.300	1.550	1.630	6.3	42
1-1/2" (41)	441551	25	1.500	1.575	1.850	1.950	7.5	46
2" (53)	441561	25	2.000	2.080	2.350	2.450	10.0	62
2-1/2" (63)	441571	25	2.500	-	2.860	3.060	12.6	80
3" (78)	441581	25	3.000	-	3.360	3.560	15.0	93
3-1/2" (91)	441601	25	3.500	-	3.860	4.060	17.5	115
4" (103)	441591	25	4.000	-	4.360	4.560	20.1	135

STEEL-FLEX SERIES

STEEL FLEX RWS NON-JACKETED FLEXIBLE CONDUIT

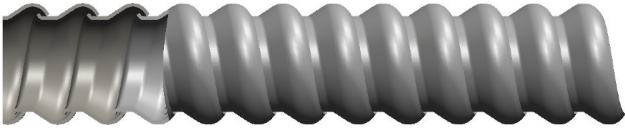

DESCRIPTION

- Non-jacketed galvanized steel flexible conduit
- Designed for commercial and industrial applications in the US market
- Available in custom cut lengths

NEC Articles

- 300.22 (C) Other spaces used for Environmental Air (Plenums)
- 250.102, 250.118(5) and 250.134(B) Equipment Grounding
- 348 Flexible Metal Conduit (FMC)
- 501.30(B) Class I Div. 2

SPECIFICATIONS:

- Galvanized steel strip-wound core, non-jacketed
- Temperature: +450°F (232°C) max.
- UL Approved #E98045
- NEMA 1 Enclosure

APPLICATIONS

- Commercial and industrial applications where liquid-tight protection is not required and UL approval is needed
- Permitted to be used in exposed and concealed locations (Article 348.10); enclosed motor leads (Article 430.245 (B)); elevators, escalators, wheelchair lifts (Article 620.21). Not for wet locations.



Modified S Profile 3/8" - 4"



Trade Size (mm)	Item ID	Std. Pkg. ft	Inside Diameter		Outside Diameter		Bend Radius	Weight lbs/cft
			Min	Max	Min	Max		
3/8" (12)	455503	100	0.375	0.393	0.560	0.610	2.0	18
	455506	500						
	455507	1000						
1/2" (16)	455513	100	0.625	0.645	0.860	0.920	3.0	32
	455526	500						
	455517	1000						
3/4" (21)	455523	100	0.812	0.835	1.045	1.105	4.0	41
	455526	500						
	455527	1000						
1" (27)	455532	50	1.000	1.040	1.300	1.380	5.0	78
	455533	300						
1-1/4" (35)	455542	50	1.250	1.300	1.550	1.630	6.3	90
	455543	200						
1-1/2" (41)	455551	25	1.500	1.575	1.850	1.950	7.5	116
	455553	150						
2" (53)	455561	25	2.000	2.080	2.350	2.450	10.0	148
	455563	100						
2-1/2" (63)	455571	25	2.500	-	2.860	3.060	12.5	165
	455573	100						
3" (78)	455581	25	3.000	-	3.360	3.560	15	197
	455583	100						
3-1/2" (91)	455601	25	3.500	-	3.860	4.060	17.5	230
	455603	100						
4" (103)	455591	25	4.000	-	4.360	4.560	20	263
	455593	100						

ULTRA-FLEX SERIES

STEEL FLEX DSL NON-JACKETED EXTRA FLEXIBLE STEEL CONDUIT

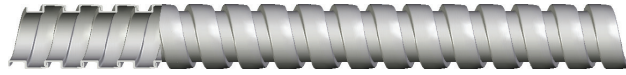

SPECIFICATIONS

- Constructed of continuously interlocked hot dipped zinc galvanized steel core for exceptional crush and corrosion resistance
- Temperature: +450°F (+232°C) max.
- Exceptional flexibility for tight "U" bend radius

APPLICATIONS

- OEM applications where tight bend radius is required, but no approvals are required

DESCRIPTION

- Ultra flexible galvanized steel conduit
- Designed for OEM applications where high flexibility but no approvals are required
- Installs easily using standard armored or flexible conduit connectors
- Available in custom cut lengths



Square-Locked Design



Actual ID Size	Description ID	Item ID	Std. Pkg. ft	Inside Diameter Min	Outside Diameter Max	Bend Radius	Weight lbs/cft
3/16"	DSL-3	460012	250	0.188	0.275	1	5
1/4"	DSL-4	460022	250	0.250	0.350	1	6
5/16"	DSL-5	460032	250	0.313	0.432	1.2	7
3/8"	DSL-6	460042	250	0.375	0.498	1.5	9
7/16"	DSL-7	460052	250	0.438	0.565	1.5	10
1/2"	DSL-8	460057	250	0.500	0.633	1.5	12
9/16"	DSL-9	460067	250	0.563	0.700	1.5	14
5/8"	DSL-10	460072	250	0.625	0.763	2.0	19
3/4"	DSL-12	460077	150	0.750	0.895	2.0	24

ULTRA-FLEX SERIES

STEEL FLEX DE-710 STANDARD FLEXIBLE CONDUIT

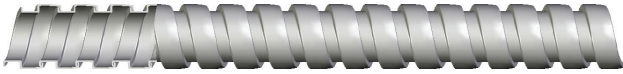

DESCRIPTION

- Ultra flexible galvanized steel conduit
- Designed for OEM applications in the office furniture and medical industries
- CSA Report No. LO-4000, 4158
- UL Recognized File No. E39679
- Also available in an OVAL version (consult factory)
- Available in custom cut lengths

SPECIFICATIONS

- Constructed of continuously interlocked hot dipped zinc galvanized steel core for exceptional crush and corrosion resistance
- Temperature: +450°F (+232°C) max.
- Exceptional flexibility for tight "U" bend radius
- UL Recognized: #E-39679, DXUZ2
- CSA Acceptable. CSA Report No. LO 4000-4158

APPLICATIONS

- OEM applications in office furniture and medical markets



Square-Locked Design

DE-710:



Actual ID Size	Item ID	Std. Pkg. ft	Inside Diameter Min	Outside Diameter		Bend Radius	Weight lbs/cft
				Min	Max		
5/16"	452100	Available In Random Lengths	0.313	0.456	0.481	1.3	11
3/8"	452105		0.375	0.519	0.544	1.3	12
7/16"	452110		0.438	0.581	0.606	1.5	13
1/2"	452115		0.500	0.644	0.669	1.5	15
9/16"	452120		0.563	0.708	0.731	1.5	19
5/8"	452125		0.594	0.738	0.763	1.8	17
3/4"	452130		0.696	0.840	0.870	2.3	20

SS ULTRA-FLEX SERIES

STAINLESS STEEL ULTRA-FLEX SL / UI CAP ULTRA FLEXIBLE STAINLESS STEEL CONDUIT

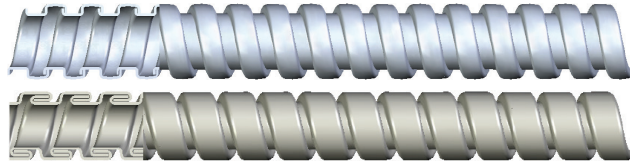

DESCRIPTION

- Flexible Stainless Steel conduit
- Designed for OEM applications where corrosion is an issue and no approvals are required
- Available in custom cut lengths

SPECIFICATIONS

- Type 304 stainless steel square-locked (SL) or fully-interlocked (UI-Cap)
- Temperature: +450°F (+232°C) max.

APPLICATIONS

- Applications where corrosion is an issue and where no approvals are required
- Sensor cable protection
- OEM probe cables
- Fiberoptics
- Instrumentation
- Temperature measuring devices

SL:



Square-Locked Design



Actual ID Size	Item ID	Std. Pkg. ft	Inside Diameter Min	Outside Diameter		Bend Radius	Weight lbs/cft
				Min	Max		
1/8"	460610-0070	Available In Random Lengths	0.125	0.195	0.207	1	2.3
5/32"	460613-0070		0.152	0.232	0.244	1	3.4
3/16"	460616-0074		0.183	0.263	0.275	1	3.7
7/32"	460619-0070		0.206	0.291	0.306	1	4.1
1/4"	460622-0074		0.245	0.330	0.345	1.3	4.8
9/32"	460626-0070		0.286	0.361	0.376	1.3	5.4
5/16"	460628-0070		0.302	0.412	0.427	1.3	6.7
3/8"	460634-0074		0.363	0.473	0.493	1.5	7.9
1/2"	460643-0070		0.483	0.603	0.623	1.5	10.8
5/8"	460652-0070		0.605	0.735	0.755	2.0	12.2

UI CAP:



Interlocked Design



Actual ID Size	Item ID	Std. Pkg. ft	Inside Diameter Min	Outside Diameter		Bend Radius	Weight lbs/cft
				Min	Max		
5/32"	451550-0070	Available In Random Lengths	0.160	0.255	0.270	1.5	4.2
3/16"	451554-0070		0.180	0.275	0.290	1.5	4.9
7/32"	451560-0070		0.215	0.310	0.325	1.5	6.6
1/4"	451564-0070		0.245	0.340	0.355	1.5	7.3
5/16"	451568-0070		0.310	0.405	0.420	1.5	8.9
3/8"	451572-0070		0.370	0.485	0.505	2	12
7/16"	451574-0070		0.432	0.547	0.567	2.5	14.7
1/2"	451576-0070		0.495	0.610	0.630	2.5	16.5



LIQUID-TIGHT FLEXIBLE METAL CONDUIT (LFMC) SEALTITE® SERIES

SEALTITE® flexible conduits are available in a wide variety of materials, diameters, and constructions, with a number of different jackets to meet the needs of your industrial, OEM, and commercial applications.

ANAMET has SEALTITE® brand fittings to match our conduits in various materials, depending on what is best for your application. Fittings are available in different threads and in straight and 90°.

SEALTITE® SERIES

SEALTITE® UA UL & CSA APPROVED FLEXIBLE CONDUIT

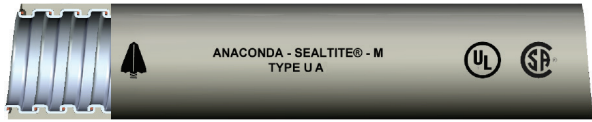

DESCRIPTION

- Liquid-tight Flexible Metal Conduit
- Designed for applications where UL & CSA approval is required or desirable
- Approved for direct burial and in concrete
- Uses standard liquid-tight connectors for easy installation
- Protection of 1000 volt and lower potential circuits
- UL certified for temperature ranges -40 deg F to +176 deg F (-40 deg C to + 80 deg C). CSA certified for 60 deg C dry / 60 deg C oil.

COMMON NEC Articles

- 300.22 (C) Other spaces used for Environmental Air (Plenums)
- 250.102, 250.118(5) and 250.134(B) Equipment Grounding
- 501.10 (B) (2) Class I Div. 2; 502.10 (A) (2) and (B) (2) Class II Dive 1 & 2; 503.10 (A) (3) and (B) Class III Div. 1 & 2
- 350 Liquid-tight Flexible Metal Conduit (LFMC)

SPECIFICATIONS:

- Galvanized steel core with liquid-tight PVC jacket
- Color: Gray, Black, and custom colors
- Temp. range: -40°F to +176°F (-40°C to + 80°C)
- UV (sunlight) resistant
- Corrosion resistant
- UL Approved #E18917
- CSA Approved #LL15275

APPLICATIONS:

- Applications where UL and CSA approvals are required



Square-Locked Design with integral bonding wire 3/8" - 1-1/4"



Interlocked Design 1-1/2" - 4" with no bonding wire



Trade Size (mm)	Item ID	Std. Pkg. ft	Inside Diameter		Outside Diameter		Bend Radius	Weight lbs/cft
			Min	Max	Min	Max		
3/8" (12)	34202	100	0.484	0.504	0.690	0.710	3.0	25
	34203	1500						
1/2" (16)	34212	100	0.622	0.642	0.822	0.840	3.5	29
	34214	500						
	34213	1000						
3/4" (21)	34222	100	0.820	0.840	1.030	1.050	5.0	44
	34228	500						
	34229	1000						
1" (27)	34231	100	1.041	1.066	1.290	1.315	6.3	73
	34238	400						
1-1/4" (35)	34241	50	1.380	1.410	1.630	1.660	7.0	100
	34248	250						
1-1/2" (41)	34251	50	1.575	1.600	1.865	1.900	5.5	112
	34254	150						
2" (53)	34261	50	2.020	2.045	2.340	2.375	7.0	148
	34268	100						
2-1/2" (63)	34272	25	2.480	2.505	2.840	2.875	9.5	182
	34274	100						
3" (78)	34281	25	3.070	3.100	3.460	3.500	15.0	255
	34284	100						
3-1/2" (89)	34301	25	3.500	3.540	3.960	4.000	16	314
	34304	100						
4" (103)	34291	25	4.000	4.040	4.460	4.500	17.0	362
	34294	100						

FITTINGS FINDER



PAGE 33-34



PAGE 34-35



PAGE 37-38

METALLIC
SEALTITE®

SEALTITE® SERIES

SEALTITE® CW-BLUE COMPUTER FLEXIBLE CONDUIT



DESCRIPTION:

- Flexible metal core liquid-tight conduit
- Uses standard liquid-tight connectors for easy installation
- Available in custom cut lengths

APPLICATIONS:

- Used to protect cables on information technology equipment in data centers.
- approved for direct burial and in concrete trade sizes 1/2"-3"

COMMON NEC Articles

- 300.22 (C) Other spaces used for Environmental Air (Plenums)
- 250.102, 250.118(5) and 250.134(B) Equipment Grounding
- 501.10 (B) (2) Class I Div. 2; 502.10 (A) (2) and (B) (2) Class II Dive 1 & 2; 503.10 (A) (3) and (B) Class III Div. 1 & 2
- 350 Liquid-tight Flexible Metal Conduit (LFMC)
- 645.5 (E) (2) Under raised floors

SPECIFICATIONS:

- Galvanized steel core with liquid-tight PVC jacket
- Color: Blue
- Temp. range: -40°F to +176°F (-40°C to +80°C)
- UV (sunlight) resistant
- Corrosion resistant
- Protection of 1000 volt and lower potential circuits
- Approved as an equipment grounding conductor in sizes 3/8" through 1-1/4" if the total grounding path is 6 ft. or less, and the circuit conductors are protected by overcurrent devices rated at 20 amps or less for 3/8" and 1/2" and 60 amps or less for 3/4" through 1-1/4".
- Complies with UL standard 360 File No. E18917; CSA C22.2 File No. LL15275; and NEC article 350.



Square-Locked Design with integral bonding wire 1/2" - 1-1/4"

Interlocked Design 1-1/2" - 3" with no bonding wire



Trade Size (mm)	Item ID	Std. Pkg. m (ft)	Inside Diameter		Outside Diameter		Bend Radius	Weight lbs/cft
			Min	Max	Min	Max		
1/2" (16)	34512	100	0.622	0.642	0.820	0.840	3.0	28
	34514	500						
	34513	1000						
3/4" (21)	34522	100	0.820	0.840	1.030	1.050	4.0	37
	34528	500						
	34526	1000						
1" (27)	34531	100	1.041	1.066	1.290	1.315	6.4	54
	34538	400						
1-1/4" (35)	34541	50	1.380	1.410	1.630	1.660	7.0	76
	34548	250						
1-1/2" (41)	34551	50	1.575	1.600	1.865	1.900	5.5	97
	34554	150						
2" (53)	34561	50	2.020	2.045	2.340	2.375	7.0	112
	34568	100						
2-1/2" (63)	34571	50	2.480	2.505	2.840	2.875	9.5	182
	34574	100						
3" (78)	34581	25	3.070	3.100	3.460	3.500	15	255

FITTINGS FINDER



PAGE 33-34



PAGE 34-35



PAGE 37-38

SEALTITE® SERIES

SEALTITE® EFST EXTRA FLEXIBLE CONDUIT



DESCRIPTION:

- Flexible metal core liquid-tight conduit
- Designed for applications where no approvals are required
- Also available in black by special order
- Uses standard liquid-tight connectors for easy installation
- Available in custom cut lengths



SPECIFICATIONS:

- Galvanized steel core with liquid-tight PVC jacket
- Color: Gray and Black
- Temp. range: -4°F to + 176°F (-20°C to +80°C)
- UV (sunlight) resistant
- Corrosion resistant

APPLICATIONS:

- Applications where very small ID liquid-tight is required (ie: 1/4")
- Applications where no approvals are required



Square-Locked Design with cord packing 5/16" - 1-1/4"



Interlocked Design 1/4" and 1-1/2" - 6"

METALLIC
SEALTITE®

Trade Size (mm)	Item ID	Std. Pkg. ft.	Inside Diameter		Outside Diameter		Bend Radius	Weight lbs/cft
			Min	Max	Min	Max		
1/4"	35983	100	0.245	0.260	0.445	0.460	1.8	14
	35981	500						
5/16" (10)	35993	100	0.390	0.405	0.560	0.575	2.0	15
	35991	500						
3/8" (12)	36201	250	0.485	0.505	0.690	0.710	2.0	21
	36202	100						
	36203	1500						
	36204	800						
1/2" (16)	36211	200	0.620	0.640	0.820	0.840	2.5	25
	36212	100						
	36213	1000						
	36214	500						
3/4" (21)	36222	100	0.815	0.835	1.030	1.050	3.0	39
	36226	1000						
	36228	500						
1" (27)	36231	100	1.030	1.055	1.290	1.315	4.0	51
	36238	400						
1-1/4" (35)	36241	50	1.370	1.395	1.635	1.660	4.5	66
	36248	250						
1-1/2" (41)	36251	50	1.575	1.600	1.865	1.900	5.5	104
	36254	150						
2" (53)	36261	50	2.020	2.045	2.340	2.375	7.0	136
	36268	100						
2-1/2"	34271	25	2.480	2.505	2.840	2.875	9.5	182
3"	34281	25	3.070	3.100	3.460	3.500	15.0	255
3-1/2"	34301	25	3.500	3.540	3.960	4.000	16.0	314
4"	34291	25	4.000	4.040	4.460	4.500	17.0	363
5"	36351	25	4.975	5.035	5.505	5.565	22.0	534
6"	36361	25	6.015	6.075	6.565	6.625	30.0	666

FITTINGS FINDER



PAGE 33-34



PAGE 34-35



PAGE 37-38

SEALTITE® SERIES

SEALTITE® EF EXTRA FLEXIBLE CONDUIT



SPECIFICATIONS:

- Galvanized steel core with liquid-tight PVC jacket
- Color: Gray or Black
- Temp. range: -4°F to + 176°F (-20°C to +80°C)
- UV (sunlight) resistant
- Corrosion resistant

APPLICATIONS:

- Applications where no approvals are required

DESCRIPTION:

- Flexible metal core liquid-tight conduit
- Designed for applications where no approvals are required
- Also available in black by special order
- Uses standard liquid-tight connectors for easy installation
- Available in custom cut lengths



Square-Locked Design 3/8" - 2"



Trade Size (mm)	Item ID	Std. Pkg. ft	Inside Diameter		Outside Diameter		Bend Radius	Weight lbs/cft
			Min	Max	Min	Max		
3/8" (12)	39402	100	0.485	0.505	0.690	0.710	2.0	21
	39404	800						
1/2" (16)	39412	100	0.620	0.640	0.820	0.840	2.5	25
	39413	1000						
	39414	500						
3/4" (21)	39422	100	0.815	0.835	1.030	1.050	3.0	39
	39428	500						
	39429	1000						
1" (27)	39431	100	1.030	1.055	1.290	1.315	4.0	51
	39438	400						
1-1/4" (35)	39441	50	1.370	1.395	1.635	1.660	4.5	66
	39448	250						
1-1/2" (41)	39451	50	1.575	1.600	1.865	1.900	5.5	104
	39454	150						
2" (53)	39461	50	2.020	2.045	2.340	2.375	7.0	136
	39468	100						

FITTINGS FINDER



PAGE 33-34



PAGE 34-35



PAGE 37-38

SEALTITE® SERIES

SEALTITE® OR OIL-RESISTANT FLEXIBLE CONDUIT



DESCRIPTION:

- Flexible metal core liquid-tight conduit
- Designed for applications that need superior resistance to petroleum, synthetic oils and chemical degradation
- Uses standard liquid-tight connectors for easy installation

SPECIFICATIONS

- Galvanized steel core with liquid-tight PVC jacket
- Color: Black
- Temp. range: -9°F to + 221°F (-23°C to +105°C)
- UV (sunlight) resistant
- Corrosion resistant
- Extra oil resistant

APPLICATIONS

- Extreme resistance to oil
- Petrochemical and steel industries
- Applications where no approvals are required

METALLIC
SEALTITE®



Square-Locked Design with
cord packing 3/8" - 1-1/4"

Interlocked Design 1-1/2" - 2"



Trade Size (mm)	Item ID	Std. Pkg. ft	Inside Diameter		Outside Diameter		Bend Radius	Weight lbs/cft
			Min	Max	Min	Max		
3/8" (12)	36602	100	0.485	0.505	0.690	0.710	2.0	21
	36604	800						
1/2" (16)	36612	100	0.620	0.640	0.820	0.840	2.5	25
	36614	500						
3/4" (21)	36622	100	0.815	0.635	1.030	1.050	3.0	39
	36628	500						
1" (27)	36631	100	1.030	1.055	1.290	1.315	4.0	51
	36638	400						
1-1/4" (35)	36641	50	1.370	1.395	1.635	1.660	4.5	66
	36648	250						
1-1/2" (41)	36651	50	1.575	1.600	1.865	1.900	5.5	104
	36654	150						
2" (53)	36661	50	2.020	2.045	2.340	2.375	7.0	136
	36668	100						

FITTINGS FINDER



PAGE 33-34



PAGE 34-35



PAGE 37-38

SEALTITE® SERIES

SEALTITE® MTC MACHINE TOOL EXTRA FLEXIBLE CONDUIT



DESCRIPTION

- Flexible metal core liquid-tight conduit
- Designed for Machine Tool industry for high flexibility
- Very tight bend radius making installation easier
- Uses standard liquid-tight connectors for easy installation

SPECIFICATIONS

- Galvanized steel core with liquid-tight PVC jacket
- Color: Black
- Temp. range: (-4°F to + 140°F) -20°C to +60°C
- UV (sunlight) resistant
- Corrosion resistant
- Tight bend radius

APPLICATIONS

- High flexibility
- Machine tool industry



Square-Locked Design
3/8" - 2"



Trade Size (mm)	Item ID	Std. Pkg. ft	Inside Diameter		Outside Diameter		Bend Radius	Weight lbs/cft
			Min	Max	Min	Max		
3/8" (12)	38302	100	0.484	0.505	0.679	0.704	1.5	16
	38304	800						
1/2" (16)	38312	100	0.622	0.640	0.818	0.843	2.0	20
	38314	500						
3/4" (21)	38322	100	0.820	0.835	1.009	1.034	2.5	24
	38328	500						
1" (27)	38331	100	1.041	1.055	1.228	1.258	3.0	30
	38338	400						
1-1/4" (35)	38341	100	1.380	1.395	1.565	1.595	3.5	40
	38348	250						
1-1/2" (41)	38351	100	1.575	1.600	1.830	1.860	4.0	70
	38354	150						
2" (53)	38361	50	2.020	2.045	2.270	2.300	5.0	87
	38638	100						

FITTINGS FINDER



PAGE 33-34



PAGE 34-35



PAGE 37-38

HIGH-TEMP SERIES

SEALTITE® HC HIGH TEMPERATURE FLEXIBLE CONDUIT



DESCRIPTION

- Flexible metal core liquid-tight conduit
- Designed for applications where a higher temperature range and where agency approvals are not required
- Manufactured in a full range of trade sizes from 3/8" up to 4"
- Uses standard liquid-tight connectors for easy installation

SPECIFICATIONS

- Galvanized steel core with liquid-tight PVC jacket
- Color: Gray and Black
- Temp. range: (-51°F to + 221°F) -46°C to +105°C
- UV (sunlight) resistant
- Corrosion resistant

APPLICATIONS

- Applications for high and low temperature where UL and CSA approvals are not required
- Steel and petrochemicals industries

METALLIC
SEALTITE®

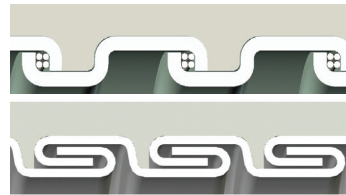

Square-Locked Design string packing 3/8" - 1-1/4"

Interlocked Design 1-1/2" - 4"



Trade Size (mm)	Item ID	Std. Pkg. ft	Inside Diameter		Outside Diameter		Bend Radius	Weight lbs/cft
			Min	Max	Min	Max		
3/8" (12)	37202	100	0.485	0.505	0.690	0.710	2.0	21
	37204	800						
1/2" (16)	37212	100	0.620	0.640	0.820	0.840	2.5	25
	37214	500						
3/4" (21)	37222	100	0.815	0.835	1.030	1.050	3.0	39
	37228	500						
1" (27)	37231	100	1.030	1.055	1.290	1.315	4.0	51
	37238	400						
1-1/4" (35)	37241	50	1.370	1.395	1.630	1.660	4.5	66
	37248	250						
1-1/2" (41)	37251	50	1.575	1.600	1.865	1.900	5.5	104
	37254	150						
2" (53)	37261	50	2.020	2.045	2.340	2.375	7.0	136
	37268	100						
3" (78)	37281	25	3.070	3.100	3.460	3.500	15.0	255
4" (103)	37291	25	4.000	4.040	4.460	4.500	17.0	362

FITTINGS FINDER



PAGE 33-34



PAGE 34-35



PAGE 37-38

HIGH-TEMP SERIES

SEALTITE® HTUA UL/CSA HIGH TEMPERATURE FLEXIBLE CONDUIT

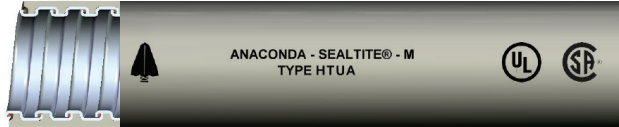

DESCRIPTION

- Flexible metal core liquid-tight conduit
- Designed for applications where a higher temperature range with UL approval is required or desired
- Approved for direct burial and in concrete applications up to 4"
- Also available in black by special order
- Uses standard liquid-tight connectors for easy installation

COMMON NEC Articles

- 300.22 (C) Other spaces used for Environmental Air (Plenums)
- 250.102, 250.118(5) and 250.134(B) Equipment Grounding
- 501.10 (B) (2) Class I Div. 2; 502.10 (A) (2) and (B) (2) Class II Dive 1 & 2; 503.10 (A) (3) and (B) Class III Div. 1 & 2
- 350 Liquid-tight Flexible Metal Conduit (LFMC)

SPECIFICATIONS

- Galvanized steel core with liquid-tight PVC jacket
- Color: Gray
- Temp. range: -51°F to + 221°F (-46°C to +105°C)
CSA max +167°F (+75°C)
- UV (sunlight) resistant
- Corrosion resistant
- UL Approved #E18917
- CSA Approved #LL15275

APPLICATIONS

- Applications for high and low temperature where UL and CSA approvals are required
- Steel and petrochemicals industries

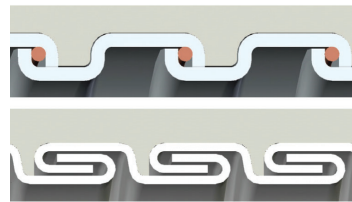

Square-Locked Design
with integral bonding wire
3/8" - 1-1/4"

Interlocked Design 1-1/2" -
4" with no bonding wire



Trade Size (mm)	Item ID	Std. Pkg. ft	Inside Diameter		Outside Diameter		Bend Radius	Weight lbs/cft
			Min	Max	Min	Max		
3/8" (12)	37402	100	0.484	0.504	0.690	0.710	3.0	24
	37404	800						
1/2" (16)	37412	100	0.622	0.642	0.820	0.840	3.5	29
	37414	500						
3/4" (21)	37422	100	0.820	0.840	1.030	1.050	5.0	43
	37428	500						
1" (27)	37431	100	1.041	1.066	1.290	1.315	6.0	73
	37438	400						
1-1/4" (35)	37441	50	1.380	1.410	1.630	1.660	7.0	100
	37448	250						
1-1/2" (41)	37451	50	1.575	1.600	1.865	1.900	5.5	112
	37454	150						
2" (53)	37461	50	2.020	2.045	2.340	2.375	7.0	148
	37468	100						
2-1/2" (63)	37471	50	2.480	2.505	2.840	2.875	9.5	181
3" (78)	37481	25	3.070	3.100	3.460	3.500	15.0	255
3-1/2" (91)	37301	25	3.500	3.540	3.960	4.000	16.0	305
4" (103)	37491	25	4.000	4.040	4.460	4.500	17.0	361

FITTINGS FINDER



PAGE 33-34



PAGE 34-35



PAGE 37-38

HIGH-TEMP SERIES

SEALTITE® HCX EXTREME TEMPERATURE FLEXIBLE CONDUIT



SPECIFICATIONS

- Galvanized steel core with liquid-tight TPE jacket
- Color: Black
- Temp. range: Static installations -76°F to +302°F (-60°C to +150°C). Dynamic installations at atmospheric pressure rated for -76°F to +221°F (-60°C to +105°C)
- UV (sunlight) resistant
- Extra corrosion resistant
- Oil resistant

METALLIC
SEALTITE®

DESCRIPTION

- Flexible metal core liquid-tight conduit
- Designed for extreme temperature applications where superior resistance to temperature ranges is required. (-76°F to +302°F)
- Available standard in black
- Uses standard liquid-tight connectors for easy installation

APPLICATIONS

- Extreme duty applications
- Extreme high or low temperature requirements
- Applications where no approvals are required



Square-Locked Design with cord packing 3/8" - 1-1/4"



Interlocked Design 1-1/2" - 2"



Trade Size (mm)	Item ID	Std. Pkg. ft	Inside Diameter		Outside Diameter		Bend Radius	Weight lbs/cft
			Min	Max	Min	Max		
3/8" (12)	39102	100	0.485	0.505	0.690	0.710	2.0	21
1/2" (16)	39112	100	0.620	0.640	0.820	0.840	2.5	25
3/4" (21)	39122	100	0.815	0.835	1.030	1.050	3.0	39
1" (27)	39131	100	1.030	1.055	1.290	1.315	4.0	51
1-1/4" (35)	39141	50	1.370	1.395	1.635	1.660	4.5	66
1-1/2" (41)	39151	50	1.575	1.600	1.865	1.900	5.5	104
2" (53)	39161	50	2.020	2.045	2.340	2.375	7.0	136

FITTINGS FINDER



PAGE 33-34



PAGE 34-35



PAGE 37-38

HIGH-TEMP SERIES

SEALTITE® HCSS HOT AND COLD TEMPERATURE 316 STAINLESS STEEL CONDUIT



DESCRIPTION

- Constructed of continuously interlocked 316 stainless steel core for exceptional crush and corrosion resistance.
- Durable, sunlight resistant thermoplastic PVC jacket that resists heat, oil and chemical breakdown.
- IP 66/67 Rated when installed with approved fittings.
- Also available in black by special order
- Uses standard liquid-tight connectors for easy installation

SPECIFICATIONS

- 316 stainless steel core with liquid-tight PVC jacket
- Color: Gray
- Temp. range: -51°F to +221°F (-46°C to +105°C)
- UV (sunlight) resistant
- Corrosion resistant

APPLICATIONS

- Applications of high and low temperature where a high level of corrosion resistance is required
- Superior wiring protection for petrochemical and offshore industries



Square-Locked Design with cord packing 3/8" - 1-1/4"



Interlocked Design 1-1/2" - 2"



Trade Size (mm)	Item ID	Std. Pkg. m (ft)	Inside Diameter		Outside Diameter		Bend Radius	Weight lbs/cft
			Min	Max	Min	Max		
3/8" (12)	47202	100	0.484	0.504	0.690	0.710	2.0	21
	47208	500						
1/2" (16)	47212	100	0.622	0.642	0.820	0.840	2.5	25
	47214	500						
3/4" (21)	47222	100	0.820	0.840	1.030	1.050	3.0	39
	47228	500						
1" (27)	47231	100	1.041	1.066	1.290	1.315	4.0	51
	47238	400						
1-1/4" (35)	47241	50	1.380	1.405	1.630	1.660	4.5	66
	47248	250						
1-1/2" (41)	47251	50	1.575	1.600	1.865	1.900	5.5	104
	47254	150						
2" (53)	47261	50	2.020	2.045	2.340	2.375	7.0	136
	47268	100						

FITTINGS FINDER



PAGE 33-34



PAGE 34-35



PAGE 37-38

HIGH-TEMP SERIES

SEALTITE® XTHF LOW TEMPERATURE FLEXIBLE CONDUIT



DESCRIPTION

- Liquid-tight Flexible Metal Conduit
- Uses standard liquid-tight connectors for easy installation
- Rated for temperature range of --94°F to +392°F (-70°C to +200°C) and incursions up to 500°F (260°C)
- Can be used in applications that do not require approvals
- Exceptional crush and corrosion resistance
- Durable, sunlight resistant, flame retardant, low smoke and zero halogen silicone jacket that resists heat, oil and corrosive chemical breakdown.
- Flexible metal core meets "Construction" requirements of UL Std. 360 sizes 1/2" through 1"

MEETS CHEMICAL COMPATIBILITY (MIL STD 810F, 504)

- Fuel - Jet Propellant 8
- Hydraulic fluid - Royco 756
- Lube oil - Royco 500
- Cleaner - Calla 855
- Solvent (Isopropyl Alcohol) - TT-I-735
- De-Icer - E36 Runway De-Icer
- Coolant - Coolanol 25R
- Fire Extinguisher foam - Amerex AFFF

SPECIFICATIONS

- Hot dipped zinc galvanized steel core with silicone jacket
- Color: Gray
- Temp. range: -94°F to +392°F (-70°C to +200°C)
- UV (sunlight) resistant. flame retardant, halogen free

APPLICATIONS

- Designed for the most extreme temperature applications
- Silicone jacket has superior resistance to chemical breakdown



Square-Locked Design with integral bonding wire 1/2" - 1"

MEETS or EXCEEDS the following STANDARDS

- Flame Resistant IEC 60614-1
- Halogen Free IEC 60614-1
- Toxicity Index NES 713 (1.0)
- Low Smoke Index NES 711
- Solar Weathering IEC 60068-2-5
- Oxygen Index 29.2



Trade Size (mm)	Item ID	Std. Pkg. ft	Inside Diameter		Outside Diameter		Bend Radius	Weight lbs/cft
			Min	Max	Min	Max		
1/2" (16)	34712	100	0.622	0.642	0.822	0.840	3.5	30
3/4" (21)	34722	100	0.820	0.840	1.030	1.050	5.0	43
1" (27)	34731	100	1.041	1.066	1.290	1.315	6.0	71

FITTINGS FINDER



PAGE 33-34



PAGE 34-35



PAGE 37-38

METALLIC
SEALTITE®

SEALTITE® SERIES

SEALTITE® EFL ALUMINUM CORE FLEXIBLE CONDUIT



DESCRIPTION

- Flexible aluminum core liquid-tight conduit
- Designed for applications where weight is a major concern, such as the transportation industry
- Lightweight
- Uses standard liquid-tight connectors for easy installation

SPECIFICATIONS

- Aluminum core with liquid-tight PVC jacket
- Color: Gray
- Temp. range: -4°F to + 176°F (-20°C to +80°C)
- UV (sunlight) resistant
- Corrosion resistant

APPLICATIONS

- Applications where weight is a concern
- Rail cars and locomotives
- Transport trucks/trailers
- Applications where no approvals are required

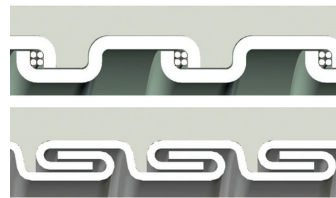

Square-Locked Design with cord packing 3/8" - 1-1/4"

Interlocked Design 1-1/2" - 4"



Trade Size (mm)	Item ID	Std. Pkg. ft	Inside Diameter		Outside Diameter		Bend Radius	Weight lbs/cft
			Min	Max	Min	Max		
3/8" (12)	38002	100	0.485	0.505	0.690	0.710	2.0	14
1/2" (16)	38012	100	0.620	0.640	0.820	0.840	2.5	16
3/4" (21)	38022	100	0.815	0.835	1.030	1.050	3.0	19
1" (27)	38031	100	1.030	1.055	1.290	1.315	4.0	32
1-1/4" (35)	38041	50	1.370	1.395	1.635	1.660	4.5	42
1-1/2" (41)	38051	50	1.575	1.600	1.865	1.900	5.5	58
2" (53)	38061	50	2.020	2.045	2.340	2.375	7.0	78
2-1/2" (63)	38071	50	2.480	2.505	2.840	2.875	9.5	103
3" (78)	38081	25	3.070	3.100	3.460	3.500	15.0	123
4" (103)	38091	25	4.000	4.040	4.460	4.500	17.0	196

FITTINGS FINDER



PAGE 33-34



PAGE 34-35



PAGE 37-38

SEALTITE® SERIES

SEALTITE® ZHUA ZERO HALOGEN/LOW SMOKE FLEXIBLE CONDUIT



DESCRIPTION

- Flexible metal core liquid-tight conduit
- Special Polyurethane jacket providing maximum protection from toxic gases, smoke density, carbon monoxide levels and HCL levels. Halogen free, flame retardant and low smoke
- Resists heat, oil and chemical breakdown
- Designed for commercial applications where Zero Halogen and Low Smoke standards are required
- Uses standard liquid-tight connectors for easy installation

COMMON NEC Articles

- 300.22 (C) Environmental Air (Plenums)
- 250.102, 250.118(5) and 250.134(B) Equipment Grounding
- 501.10 (B) (2) Class I Div. 2; 502.10 (A) (2) and (B) (2) Class II Dive 1 & 2; 503.10 (A) (3) and (B) Class III Div. 1 & 2
- 350 Liquid-tight Flexible Metal Conduit (LFMC)

SPECIFICATIONS

- Galvanized steel core with liquid-tight TPU jacket
- Color: Black
- Temp. range: -40°F to + 176°F (-40°C to +80°C)
- UV (sunlight) resistant
- Corrosion resistant
- UL Approved to UL-94 V-0 and UL-360. # E18917
- Meets or exceeds: ASTM-E162 (Flame spread); ASTM-E662 (Smoke density); Bombardier SMP-800C (Toxic gas generation)
- CSA File No. LL15275

APPLICATIONS

- Commercial applications where Zero Halogen and Low Smoke conduit is specified
- Rail & aerospace transport
- Commercial buildings



Square-Locked Design with integral bonding wire 3/8" - 1-1/4"



Interlocked Design 1-1/2" - 4" with no bonding wire



Trade Size (mm)	Item ID	Std. Pkg. ft	Inside Diameter		Outside Diameter		Bend Radius	Weight lbs/cft
			Min	Max	Min	Max		
3/8" (12)	39802	100	0.484	0.504	0.690	0.710	3.0	25
	39808	500						
	39809	1000						
1/2" (16)	39812	100	0.622	0.642	0.820	0.840	3.5	29
	39814	500						
	39813	1000						
3/4" (21)	39822	100	0.820	0.840	1.030	1.050	5.0	44
	39828	500						
	39829	1000						
1" (27)	39831	100	1.041	1.066	1.290	1.315	6.0	73
	39838	400						
1-1/4" (35)	39841	50	1.380	1.410	1.630	1.660	7.0	100
	39848	250						
1-1/2" (41)	39851	50	1.575	1.600	1.865	1.900	5.5	112
	39854	150						
2" (53)	39861	50	2.020	2.045	2.340	2.375	7.0	148
	39868	100						
2-1/2" (63)	39872	25	2.480	2.505	2.840	2.875	9.5	182
3" (78)	39881	25	3.070	3.100	3.460	3.500	15.0	255
3-1/2" (91)	39791	25	3.500	3.540	3.960	4.000	16.0	314
4" (103)	39891	25	4.000	4.040	4.460	4.500	17.0	362

FITTINGS FINDER



PAGE 33-34



PAGE 34-35



PAGE 37-38

METALLIC
SEALTITE®

SEALTITE® SERIES

METALLIC
SEALTITE®

SEALTITE® HFSS ZERO HALOGEN, LOW SMOKE, LOW FLAME 316 STAINLESS STEEL CONDUIT



DESCRIPTION

- Constructed of continuously interlocked 316 stainless steel core for exceptional crush and corrosion resistance
- Durable, sunlight resistant, flame retardant, LOW SMOKE and ZERO HALOGEN TPU jacket that resists heat, oil and chemical breakdown
- Designed for most extreme temperature applications

SPECIFICATIONS

- 316 stainless steel core with liquid-tight PVC jacket
- Color: Black
- Temp. range: -40°F to +221°F (-40°C to +105°C)
- UV (sunlight) resistant
- Corrosion resistant

APPLICATIONS

- Applications of high and low temperature where a high level of corrosion resistance is required
- Safety applications where low smoke and zero halogen are required
- Rail and infrastructure applications

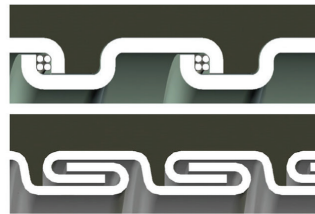

Square-Locked Design with cord packing 3/8" - 1-1/4"

Interlocked Design 1-1/2" - 2"



Trade Size (mm)	Item ID	Std. Pkg. ft	Inside Diameter		Outside Diameter		Bend Radius	Weight lbs/cft
			Min	Max	Min	Max		
3/8" (12)	49802	100	0.484	0.504	0.690	0.710	2.0	22
1/2" (16)	49812	100	0.622	0.642	0.820	0.840	2.5	24
3/4" (21)	49822	100	0.820	0.840	1.030	1.050	3.0	36
1" (27)	49831	100	1.041	1.066	1.290	1.315	4.0	50
1-1/4" (35)	49841	50	1.380	1.410	1.630	1.660	4.5	66
1-1/2" (41)	49851	50	1.575	1.600	1.865	1.900	5.5	98
2" (53)	49861	50	2.020	2.045	2.340	2.375	7.0	130

FITTINGS FINDER



PAGE 33-34



PAGE 34-35



PAGE 37-38

SPECIALTY SERIES

SEALTITE® SHIELDTITE EMI/EMP RESISTANT FLEXIBLE CONDUIT



DESCRIPTION

- Flexible bronze core liquid-tight conduit
- Designed for applications needing superior EMI and EMP shielding
- Uses standard liquid-tight connectors for easy installation

SPECIFICATIONS

- Bronze core with liquid-tight PVC jacket
- Color: Gray
- Temp. range: -51°F to + 221°F (-46°C to +105°C)
- UV (sunlight) resistant
- Corrosion resistant
- Special bronze core provides high-level shielding protection
- Meets MIL-STD-1310H
- Provides shielding effectiveness of 81-119 Db at 1 Mhz to 1 Ghz

APPLICATIONS

- Applications where high shielding is required
- Military, power generation, and communications

METALLIC
SEALTITE®



Interlocked Design 3/8" - 4"



Trade Size (mm)	Item ID	Std. Pkg. ft	Inside Diameter		Outside Diameter		Bend Radius	Weight lbs/cft
			Min	Max	Min	Max		
3/8" (12)	450200-0240	Available in Random Lengths	0.484	0.505	0.690	0.710	3.0	24
1/2" (16)	450202-0140		0.622	0.642	0.820	0.840	3.0	28
3/4" (21)	450204-0240		0.820	0.835	1.030	1.050	4.0	42
1" (27)	450206-0340		1.041	1.066	1.290	1.315	4.0	56
1-1/4" (35)	450208-0140		1.380	1.395	1.630	1.660	4.5	75
1-1/2" (41)	450210-0140		1.575	1.600	1.865	1.900	7.0	96
2" (53)	450212-0140		2.020	2.045	2.340	2.375	9.5	125
2-1/2" (63)	450214-0140		2.480	2.505	2.840	2.875	12.0	165
3" (78)	450216-0140		3.070	3.100	3.460	3.500	13.5	211
4" (103)	450220-0140		4.000	4.040	4.460	4.500	17.0	298

FITTINGS FINDER



PAGE 33-34



PAGE 34-35



PAGE 37-38

SPECIALTY SERIES

SEALTITE® SHIELDTITE Z1 EMI/EMP RESISTANT FLEXIBLE CONDUIT



DESCRIPTION

- Flexible bronze core liquid-tight conduit
- Designed for applications needing superior EMI and EMP shielding
- Uses standard liquid-tight connectors for easy installation
- Durable, sunlight resistant, flame retardant, LOW SMOKE and ZERO HALOGEN TPU jacket that resists heat, oil and chemical breakdown

SPECIFICATIONS

- Bronze core with liquid-tight PVC jacket
- Color: Gray
- Temp. range: -51°F to + 221°F (-46°C to +105°C)
- UV (sunlight) resistant
- Corrosion resistant
- Special bronze core provides high-level shielding protection
- Meets MIL-STD-1310H
- Provides shielding effectiveness of 81-119 Db at 1 Mhz to 1 Ghz

APPLICATIONS

- Applications where high shielding is required
- Military, power generation, and communications



Interlocked Design 3/8" - 4"



Trade Size (mm)	Item ID	Std. Pkg. ft	Inside Diameter		Outside Diameter		Bend Radius	Weight lbs/cft
			Min	Max	Min	Max		
3/8" (12)	450200-0185	Available in Random Lengths	0.484	0.505	0.690	0.710	3.0	24
1/2" (16)	450202-0185		0.622	0.642	0.820	0.840	3.0	28
3/4" (21)	450204-0185		0.820	0.835	1.030	1.050	4.0	42
1" (27)	450206-0185		1.041	1.066	1.290	1.315	4.0	56
1-1/4" (35)	450208-0185		1.380	1.395	1.630	1.660	4.5	75
1-1/2" (41)	450210-0185		1.575	1.600	1.865	1.900	7.0	96
2" (53)	450212-0185		2.020	2.045	2.340	2.375	9.5	125
2-1/2" (63)	450214-0185		2.480	2.505	2.840	2.875	12.0	165
3" (78)	450216-0185		3.070	3.100	3.460	3.500	13.5	211
4" (103)	450220-0185		4.000	4.040	4.460	4.500	17.0	298

FITTINGS FINDER



PAGE 33-34



PAGE 34-35



PAGE 37-38

SPECIALTY SERIES

SEALTITE® NWC RADIATION RESISTANT FLEXIBLE CONDUIT



DESCRIPTION

- Flexible metal core liquid-tight conduit
- Special polyethylene jacket that provides resistance to radiation
- Suitable for use in nuclear containment areas
- Uses standard liquid-tight connectors for easy installation

LISTING

- NUCLEAR PROCURMENT ISSUES COMMITTEE (NUPIC)
- NUPIC number 2651

SPECIFICATIONS

- Galvanized steel core with liquid-tight polyethylene jacket
- Color: Black
- Temp. range: (-40°F to + 192°F) -40°C to +89°C
- Radiation resistant
- Corrosion resistant
- Meets IEEE 323-1974 and IEEE 383-1974 guidelines
- Acceptable for use in nuclear containment areas

APPLICATIONS

- Applications requiring radiation resistance
- Power generation, military, and medical

METALLIC
SEALTITE®



Square-Locked Design with integral bonding wire 3/8" - 1-1/4"



Interlocked Design 1-1/2" - 4" with no bonding wire



Trade Size (mm)	Item ID	Std. Pkg. ft	Inside Diameter		Outside Diameter		Bend Radius	Weight lbs/cft
			Min	Max	Min	Max		
3/8" (12)	433999-0143	100	0.484	0.505	0.690	0.710	8	25
1/2" (16)	434009-0143	100	0.622	0.642	0.820	0.840	9	29
3/4" (21)	434019-0143	100	0.820	0.840	1.030	1.050	13	44
1" (27)	434029-0143	100	1.041	1.066	1.290	1.315	15	73
1-1/4" (35)	434039-0143	50	1.380	1.410	1.630	1.660	18	100
1-1/2" (41)	434049-0143	50	1.575	1.600	1.865	1.900	20	112
2" (53)	434059-0143	50	2.020	2.045	2.340	2.375	22	148
2-1/2" (63)	434069-0143	25	2.480	2.505	2.840	2.875	24	182
3" (78)	434079-0143	25	3.070	3.100	3.460	3.500	30	255
4" (103)	434089-0143	25	4.000	4.040	4.460	4.500	36	362

FITTINGS FINDER



PAGE 33-34



PAGE 34-35



PAGE 37-38

SPECIALTY SERIES

METALLIC
SEALTITE®

SEALTITE® FG FOOD GRADE FLEXIBLE CONDUIT



DESCRIPTION

- Constructed with thermoplastic PVC jacket over galvanized steel inner core
- PVC jacket specially formulated for food and beverage applications per FDA CFR 21 and NSF 51 requirements
- Jacket is easily cleaned and does not promote bacteria growth

PLACES OF INTEREST

- Food Equipment or Devices NSF/ANSI 169
- Food Equipment Manufacturers SIC 3556
- Meat Packing SIC 2011 NAICS 311613
- Poultry SIC 2015 NAICS 311615
- Pharmaceuticals SIC 2834 NAICS 325412

SPECIFICATIONS

- Galvanized steel core with thick smooth PVC cover
- Color: White
- Temp. range: -4°F to +140°F (-20°C to +60°C)
- NSF Certified to NSF / ANSI 169 for special purpose food equipment or devices

APPLICATIONS

- Suitable for food equipment or devices
- Food equipment manufacturers
- Meat packing or poultry facilities
- Pharmaceutical facilities



Square-Locked Design with cord packing from 3/8" - 1-1/4"



Interlocked Design 1-1/2" - 2"



Trade Size (mm)	Item ID	Std. Pkg. ft	Inside Diameter		Outside Diameter		Bend Radius	Weight lbs/cft
			Min	Max	Min	Max		
3/8" (12)	35502	100	0.484	0.504	0.690	0.710	2.0	21
1/2" (16)	35512	100	0.622	0.642	0.820	0.840	2.5	25
3/4" (21)	35522	100	0.820	0.840	1.030	1.050	3.0	39
1" (27)	35531	100	1.041	1.066	1.290	1.315	4.0	51
1-1/4" (35)	35541	50	1.380	1.410	1.630	1.660	4.5	66
1-1/2" (41)	35551	50	1.575	1.600	1.865	1.900	5.5	104
2" (53)	35561	50	2.020	2.045	2.340	2.375	7.0	136

FITTINGS FINDER



PAGE 33-34



PAGE 34-35



PAGE 37-38

SPECIALTY SERIES

SEALTITE® FGUA FOOD GRADE FLEXIBLE CONDUIT

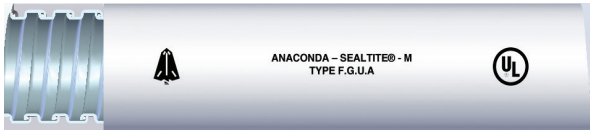

DESCRIPTION

- Constructed with thermoplastic PVC jacket over galvanized steel inner core
- PVC jacket specially formulated for food and beverage applications per FDA CFR 21 and NSF 51 requirements
- Jacket is easily cleaned and does not promote bacteria growth

COMMON NEC Articles

- 300.22 (C) Other spaces used for Environmental Air (Plenums)
- 250.102, 250.118(5) and 250.134(B) Equipment Grounding
- 501.10 (B) (2) Class I Div. 2; 502.10 (A) (2) and (B) (2) Class II Dive 1 & 2; 503.10 (A) (3) and (B) Class III Div. 1 & 2
- 350 Liquid-tight Flexible Metal Conduit (LFMC)

SPECIFICATIONS

- Galvanized steel core with thick smooth PVC cover
- Color: White
- Temp. range: -40°F to +176°F (-40°C to +80°C)
- NSF Certified to NSF / ANSI 169 for special purpose food equipment or devices

APPLICATIONS

- Splash Zone applications
- Food equipment manufacturers
- Meat packing or poultry facilities
- Pharmaceutical facilities

METALLIC
SEALTITE®



Square-Locked Design with integral bonding wire 3/8" - 1-1/4"



Interlocked Design 1-1/2" - 2"



Trade Size (mm)	Item ID	Std. Pkg. ft	Inside Diameter		Outside Diameter		Bend Radius	Weight lbs/cft
			Min	Max	Min	Max		
3/8" (12)	35302	100	0.484	0.504	0.690	0.710	2.0	21
1/2" (16)	35312	100	0.622	0.642	0.820	0.840	2.5	25
3/4" (21)	35322	100	0.820	0.840	1.030	1.050	3.0	39
1" (27)	35331	100	1.041	1.066	1.290	1.315	4.0	51
1-1/4" (35)	35341	50	1.380	1.410	1.630	1.660	4.5	66
1-1/2" (41)	35351	50	1.575	1.600	1.865	1.900	5.5	104
2" (53)	35361	50	2.020	2.045	2.340	2.375	7.0	136

FITTINGS FINDER



PAGE 33-34



PAGE 34-35



PAGE 37-38

SPECIALTY SERIES

METALLIC
SEALTITE®

SEALTITE® FGSS 316 STAINLESS STEEL FOOD GRADE FLEXIBLE CONDUIT

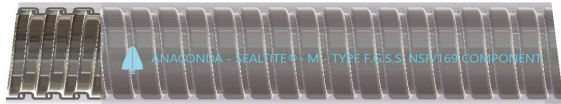

SPECIFICATIONS

- 316 Stainless steel core with thick smooth PVC cover
- Color: Clear
- Temp. range: -4°F to +140°F (-20°C to +60°C)
- NSF Certified to NSF / ANSI 169 for special purpose food equipment or devices

APPLICATIONS

- Suitable for food equipment or devices
- Food equipment manufacturers
- Meat packing or poultry facilities
- Pharmaceutical facilities

DESCRIPTION

- Constructed with thermoplastic PVC jacket over 316 stainless steel inner core
- PVC jacket specially formulated for food and beverage applications per FDA CFR 21 and NSF 51 requirements
- Jacket is easily cleaned and does not promote bacteria growth
- NSF Certified to NSF/ANSI 169 for special purpose food equipment or devices and can be used in both Food and Splash Zone rated areas.
- Delivers superior wiring protection where incidental food contact is possible.
- Conduit used with standard liquid-tight fitting for easy installation. IP 66/67 Rated when installed with approved fittings.



Square-Locked Design with cord packing 3/8" - 1-1/4"



Interlocked Design 1-1/2" - 2"



Trade Size (mm)	Item ID	Std. Pkg. ft	Inside Diameter		Outside Diameter		Bend Radius	Weight lbs/cft
			Min	Max	Min	Max		
3/8" (12)	45502	100	0.484	0.504	0.690	0.710	2.0	21
1/2" (16)	45512	100	0.622	0.642	0.820	0.840	2.5	25
3/4" (21)	45522	100	0.820	0.840	1.030	1.050	3.0	39
1" (27)	45531	100	1.041	1.066	1.290	1.315	4.0	51
1-1/4" (35)	45541	50	1.380	1.410	1.630	1.660	4.5	66
1-1/2" (41)	45551	50	1.575	1.600	1.865	1.900	5.5	104
2" (53)	45561	50	2.020	2.045	2.340	2.375	7.0	136

FITTINGS FINDER



PAGE 33-34



PAGE 34-35



PAGE 37-38



FITTINGS

SEALTITE® SERIES

ANACONDA SEALTITE® fittings are designed to the same high standards that our SEALTITE® conduit is and together provide the best possible protection for industrial, OEM, and commercial applications.

Fittings are available in various materials in order to best suit requirements, including nickel plated brass and stainless steel 304 and 316.

FITTING SELECTION GUIDE

SEALTITE®
FITTINGS

FITTING SELECTION GUIDE								
			CONSTRUCTION	HARSH ENVIRONMENT	SHIELDTITE	NMUA (NON-METALLIC) TYPE B	MTC (MACHINE TOOL)	CNP TYPE A
FITTING SERIES	STOCK ITEM Y/N	INSULATED THROAT	EF, EFST, UA, CW	HTUA, HC, HCX, ZHUA, OR, FG, EFL	PVC, ZERO HALOGEN	NMUA.	MTC	CNP
Steel Fittings LFMC Zinc-Plated	Y	Y	IP 66/67	IP 66/67	IP 66/67	NA	IP 65	NA
NPT / ISO Compact LFMC Nickel-Plated Brass	Y	Y	IP 66/67	IP 66/67	IP 66/67	NA	IP 65	NA
NPT Compact LFMC 316 Stainless Steel	Y	Y	IP 66/67	IP 66/67	IP 66/67	NA	IP 65	NA
NPT LFMC 304 Stainless Steel	Y	Y	IP 66/67	IP 66/67	IP 66/67	NA	IP 65	NA
NMUA Fittings LFNC Type B Nylon 66	Y	NA	NA	NA	NA	IP 66/67	NA	NA
Type A CNP Fittings	Y	Y	NA	NA	NA	NA	NA	IP 67

IP 65 - Protected from total dust ingress. Protected from low pressure water jets.
 IP 66 - Protected from total dust ingress. Protected from high pressure water jets from any direction.
 IP 67 - Protected from total dust ingress. Protected from immersion to 1 m depth.
 Zinc-plated fittings provide marginal corrosion resistance. Not to be used in salt or corrosive environments.
 Nickel-Plated Brass fittings provide better protection against corrosion. Use to prevent galvanic corrosion in neutral pH.
 316 Stainless Steel fittings are the best corrosion protection. Use in very harsh environments to protect against galvanic and chemical corrosion.

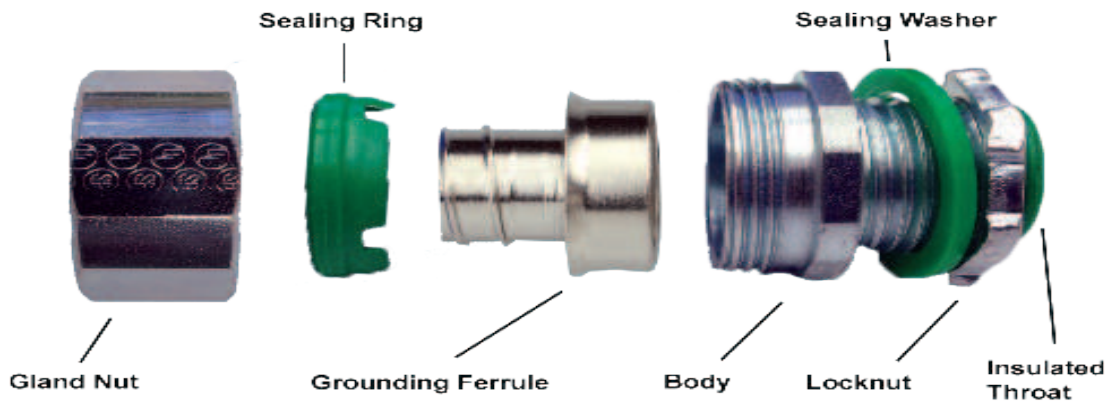

METALLIC FITTINGS

SEALTITE® COMPACT FITTINGS NICKEL PLATED BRASS PREMIUM NPT FITTINGS



DESCRIPTION

- New compact design: 20% smaller and 35% lighter than standard SEALTITE® fittings. Ideal for tight spaces
- Excellent corrosion resistance, strength and durability
- IP 66/67 rated when installed with approved conduit and tightened to UL-514B/CSA C22.2 18.3 torque specifications
- Approved for both exposed and concealed locations

SPECIFICATIONS

- Nickel Plated Brass w/ PA6 clamping ring
- O-ring included
- Color: Metallic
- Temp. range: -49° F to +221° F [-45° C to + 105° C]
- cULus Approved # E234207

APPLICATIONS

- Metallic and Type B non-metallic flexible conduit
- Compact design ideal for tight spaces
- High-end appearance for good presentation

COMMON NEC Articles

- 501.10 (B) (2) Class I Div. 2
- 502.10 (A) (2) and (B) (2) Class II Dive 1 & 2
- 503.10 (A) (3) and (B) Class III Div. 1 & 2

STRAIGHT:



Trade Size	Item ID	Min. Int. Bore (mm)	Dimensions inches				KO Size NPT	Weight kg(lb)/100	Std. Pkg.
			A	B	C	E			
3/8"	7140122IT	11.0	1.259	0.472	1.023	0.944	1/2"	10.8	10
1/2"	7140162IT	14.5	1.388	0.472	1.141	1.063	1/2"	12.1	10
3/4"	7140202IT	19.4	1.378	0.472	1.378	1.299	3/4"	17.2	10
1"	7140262IT	24.7	1.456	0.511	1.771	1.732	1"	30.6	5
1-1/4"	7140352IT	33.3	1.653	0.590	2.086	2.047	1-1/4"	41.0	4
1-1/2"	7140402IT	38.0	1.889	0.630	2.440	2.362	1-1/2"	61.7	2
2"	7140502IT	49.0	2.126	0.748	2.992	2.834	2"	97.0	2

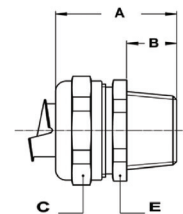

45 DEGREE:

Trade Size	Item ID	Min. Int. Bore (mm)	Dimensions inches					KO Size NPT	Weight kg(lb)/100	Std. Pkg.
			A	B	C	D	E			
3/8"	7144122IT	11.0	0.945	0.551	1.114	1.102	0.944	1/2"	19.2	10
1/2"	7144162IT	14.5	0.984	0.551	1.244	1.181	1.063	1/2"	22.3	10
3/4"	7144202IT	19.4	1.063	0.551	1.504	1.299	1.299	3/4"	36.8	4
1"	7144262IT	24.7	1.260	0.630	1.949	1.496	1.653	1"	65.3	5
1-1/4"	7144352IT	33.3	1.417	0.630	2.086	1.535	2.047	1-1/4"	95.2	2
1-1/2"	7144402IT	38.0	1.535	0.709	2.441	1.811	2.362	1-1/2"	131.2	2
2"	7144502IT	49.0	1.732	0.787	2.992	2.087	2.834	2"	206.4	2

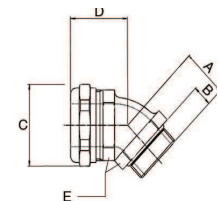

90 DEGREE:

Trade Size	Item ID	Min. Int. Bore (mm)	Dimensions inches					KO Size NPT	Weight kg(lb)/100	Std. Pkg.
			A	B	C	D	E			
3/8"	7149122IT	11.0	1.063	0.472	1.023	1.260	0.944	1/2"	19.2	10
1/2"	7149162IT	14.5	1.181	0.472	1.141	1.338	1.063	1/2"	22.3	10
3/4"	7149202IT	19.4	1.338	0.472	1.378	1.574	1.299	3/4"	36.8	4
1"	7149262IT	24.7	1.614	0.511	1.771	1.929	1.653	1"	65.3	5
1-1/4"	7149352IT	33.3	1.811	0.511	2.086	1.968	2.047	1-1/4"	95.2	2
1-1/2"	7149402IT	38.0	2.204	0.511	2.441	2.244	2.362	1-1/2"	131.2	2
2"	7149502IT	49.0	2.441	0.630	2.992	2.677	2.834	2"	206.4	2

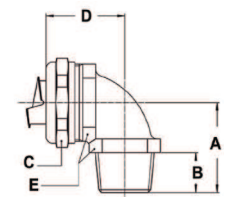

METALLIC FITTINGS

ISO SEALTITE® COMPACT FITTINGS NICKEL PLATED BRASS PREMIUM METRIC FITTINGS



SPECIFICATIONS

- Nickel Plated Brass w/ PA6 clamping ring
- O-ring included
- Color: Metallic
- Temp. range: -49° F to +221° F [-45° C to + 105° C]
- cULus Approved # E234207

APPLICATIONS

- Metallic and Type B non-metallic flexible conduit
- Compact design ideal for tight spaces
- High-end appearance for good presentation

DESCRIPTION

- New compact design: 20% smaller and 35% lighter than standard SEALTITE® fittings. Ideal for tight spaces
- Excellent corrosion resistance, strength and durability
- IP 66/67 rated when installed with approved conduit and tightened to UL-514B/CSA C22.2 18.3 torque specifications
- Approved for both exposed and concealed locations

COMMON NEC Articles

- 501.10 (B) (2) Class I Div. 2
- 502.10 (A) (2) and (B) (2) Class II Dive 1 & 2
- 503.10 (A) (3) and (B) Class III Div. 1 & 2

SEALTITE®
FITTINGS

STRAIGHT:



Trade Size	Thread ISO	Item ID	Min. Int. Bore	Dimensions mm				Weight kg(lb)/100	Std. Pkg.
				A	B	C	E		
3/8"	M16 x 1.5	7120161IT	11.0	31	10	26	24	10.8	10
3/8"	M20 x 1.5	7120171IT	11.0	31	10	26	24	10.8	10
1/2"	M20 x 1.5	7120201IT	14.5	32	10	29	27	12.1	10
3/4"	M25 x 1.5	7120251IT	19.4	33	10	35	33	17.2	10
1"	M32 x 1.5	7120321IT	24.7	36	12	45	42	30.6	5
1-1/4"	M40 x 1.5	7120401IT	33.3	40	13	53	52	41.0	2
1-1/2"	M50 x 1.5	7120501IT	38.0	46	14	62	60	61.7	2
2"	M63 x 1.5	7120631IT	49.0	52	16	76	72	97.0	2

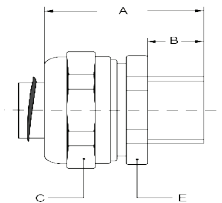

90 DEGREE:



Trade Size	Thread ISO	Item ID	Min. Int. Bore	Dimensions mm					Weight kg(lb)/100	Std. Pkg.
				A	B	C	D	E		
3/8"	M16 x 1.5	7129161IT	11.0	26	10	26	31	24	19.2	10
3/8"	M20 x 1.5	7129171IT	11.0	26	10	26	32	24	19.2	10
1/2"	M20 x 1.5	7129201IT	14.5	28	10	29	34	27	22.3	10
3/4"	M25 x 1.5	7129251IT	19.4	32	10	35	40	33	36.8	4
1"	M32 x 1.5	7129321IT	24.7	40	12	45	49	42	65.3	5
1-1/4"	M40 x 1.5	7129401IT	33.3	46	13	53	53	52	95.2	4
1-1/2"	M50 x 1.5	7129501IT	38.0	52	14	62	57	60	131.2	2
2"	M63 x 1.5	7129631IT	49.0	62	16	76	68	72	206.4	2

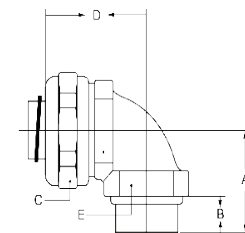

METALLIC FITTINGS

SEALTITE® STAINLESS STEEL AISI-304 PREMIUM NPT/METRIC FITTINGS



DESCRIPTION

- Stainless Steel Type 304 Fitting, has a four piece construction consisting of a gland nut, sealing ring, high tensile grounding ferrule and body
- Included sealing washer and stainless steel locknut provides a means for connecting the fitting to boxes
- IP 66/67 rated when installed with approved conduit and tightened to UL-514B/CSA C22.2 18.3 torque specifications
- Approved for both exposed and concealed locations

SPECIFICATIONS

- AISI-304 Ferrule and lock nut and PA6 clamping ring
- O-ring and lock nut included
- Color: Metallic
- Temp. range: -49° F to +221° F [-45° C to + 105° C]
- cULus Approved # E234207

APPLICATIONS

- Metallic and Type B non-metallic flexible conduit
- Premium Stainless 304 for corrosion resistance.
- Compact design for tight spaces

COMMON NEC Articles

- 501.10 (B) (2) Class I Div. 2
- 502.10 (A) (2) and (B) (2) Class II Dive 1 & 2
- 503.10 (A) (3) and (B) Class III Div. 1 & 2

SEALTITE® FITTINGS

STRAIGHT NPT:



Trade Size	Item ID	Min. Int. Bore (mm)	Dimensions inches				KO Size NPT	Weight lb/100	Std. Pkg.
			A	B	C	D			
3/8"	81401292	11.0	1.457	0.512	1.024	-	1/2"	10.8	10
1/2"	81401692	14.5	1.457	0.512	1.142	-	1/2"	12.1	10
3/4"	81402092	19.4	1.575	0.591	1.379	-	3/4"	17.2	5
1"	81402692	24.7	1.811	0.591	1.772	-	1"	30.6	5

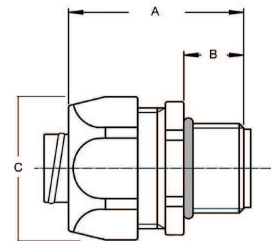

90° NPT:



Trade Size	Item ID	Min. Int. Bore (mm)	Dimensions inches				KO Size NPT	Weight lb/100	Std. Pkg.
			A	B	C	D			
3/8"	81491292	11.0	1.457	0.512	1.024	1.693	1/2"	10.8	10
1/2"	81491692	14.5	1.457	0.512	1.142	1.693	1/2"	12.1	10
3/4"	81492092	19.4	1.693	0.591	1.379	1.890	3/4"	17.2	5
1"	81492692	24.7	1.890	0.591	1.772	2.323	1"	30.6	5

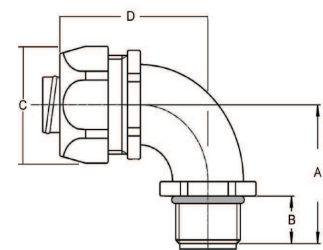

METALLIC FITTINGS

SEALTITE® COMPACT FITTINGS STAINLESS STEEL AISI-316 PREMIUM NPT FITTINGS



DESCRIPTION

- New compact design: 20% smaller and 35% lighter than standard SEALTITE® fittings which makes it ideal for tight spaces
- Superior Stainless 316 corrosion resistance, strength and durability
- IP66/67 rated when installed with approved conduit and tightened to UL-514B/CSA C22.2 18.3 torque specifications
- Approved for both exposed and concealed locations

SPECIFICATIONS

- AISI-316 body with AISI-304 Ferrule and lock nut and PA6 clamping ring
- O-ring and lock nut included
- Color: Metallic
- Temp. range: -49° F to +221° F [-45° C to + 105° C]
- cULus Approved # E234207

APPLICATIONS

- Metallic and Type B non-metallic flexible conduit
- Premium Stainless 316 for the best corrosion resistance.
- Compact design for tight spaces

COMMON NEC Articles

- 501.10 (B) (2) Class I Div. 2
- 502.10 (A) (2) and (B) (2) Class II Dive 1 & 2
- 503.10 (A) (3) and (B) Class III Div. 1 & 2

SEALTITE®
FITTINGS

STRAIGHT:



Trade Size	Item ID	Min. Int. Bore (mm)	Dimensions inches				KO Size NPT	Weight kg(lb)/100	Std. Pkg.
			A	B	C	E			
3/8"	71411292IT	11.0	1.259	0.472	1.023	0.944	1/2"	10.8	10
1/2"	71411692IT	14.5	1.388	0.472	1.141	1.063	1/2"	12.1	10
3/4"	71412092IT	19.4	1.378	0.472	1.378	1.299	3/4"	17.2	10
1"	71412692IT	24.7	1.456	0.511	1.771	1.732	1"	30.6	5
1-1/4"	71413592IT	33.3	1.653	0.590	2.086	2.047	1-1/4"	41.0	4
1-1/2"	71414092IT	38.0	1.889	0.630	2.440	2.362	1-1/2"	61.7	2
2"	71415092IT	49.0	2.126	0.748	2.992	2.834	2"	97.0	2

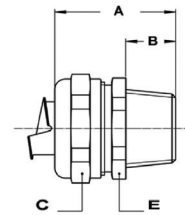

45 DEGREE:

Trade Size	Item ID	Min. Int. Bore (mm)	Dimensions inches					KO Size NPT	Weight kg(lb)/100	Std. Pkg.
			A	B	C	D	E			
3/8"	71421292IT	11.0	0.945	0.551	1.114	1.102	0.944	1/2"	19.2	10
1/2"	71421692IT	14.5	0.984	0.551	1.244	1.181	1.063	1/2"	22.3	10
3/4"	71422092IT	19.4	1.063	0.551	1.504	1.299	1.299	3/4"	36.8	4
1"	71422692IT	24.7	1.260	0.630	1.949	1.496	1.653	1"	65.3	5
1-1/4"	71423592IT	33.3	1.417	0.630	2.086	1.535	2.047	1-1/4"	95.2	2
1-1/2"	71424092IT	38.0	1.535	0.709	2.441	1.811	2.362	1-1/2"	131.2	2
2"	71425092IT	49.0	1.732	0.787	2.992	2.087	2.834	2"	206.4	2

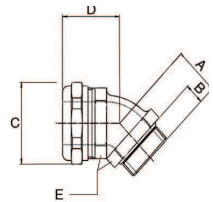

90 DEGREE:

Trade Size	Item ID	Min. Int. Bore (mm)	Dimensions inches					KO Size NPT	Weight kg(lb)/100	Std. Pkg.
			A	B	C	D	E			
3/8"	71451292IT	11.0	1.063	0.472	1.023	1.260	0.944	1/2"	19.2	10
1/2"	71451692IT	14.5	1.181	0.472	1.141	1.338	1.063	1/2"	22.3	10
3/4"	71452092IT	19.4	1.338	0.472	1.378	1.574	1.299	3/4"	36.8	4
1"	71452692IT	24.7	1.614	0.511	1.771	1.929	1.653	1"	65.3	5
1-1/4"	71453592IT	33.3	1.811	0.511	2.086	1.968	2.047	1-1/4"	95.2	2
1-1/2"	71454092IT	38.0	2.204	0.511	2.441	2.244	2.362	1-1/2"	131.2	2
2"	71455092IT	49.0	2.441	0.630	2.992	2.677	2.834	2"	206.4	2

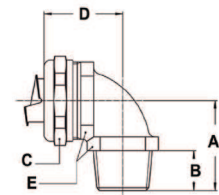

METALLIC FITTINGS

SEALTITE® FITTINGS ZINC-PLATED STEEL FITTINGS



DESCRIPTION

- Fitting is ideal for use with standard liquid-tight conduit to allow easy installation. IP 66/67 Rated when installed with approved conduit
- Included sealing washer and galvanized steel lock nut provides a means for connecting the fitting to boxes
- Approved for both exposed and concealed locations

SPECIFICATIONS

- Zinc plated steel fitting, has a five piece construction consisting of a gland nut, sealing ring, high tensile grounding ferrule, insulated throat, and body
- Color: Metallic
- Temp. range: -49° F to +221° F (-45° C to + 105° C)
- Complies with UL Standard 514B File No. E472179 category code TEOZ

APPLICATIONS

- Corrosion resistant, protects from moisture and oils
- Suitable for hazardous locations per NEC Articles 501
 - Class I Div. 2, Article 502 Class II
 - Div. 1 & 2, Article 503 Class III Div. 1 & 2

STRAIGHT:



Trade Size	Item ID	Min. Int. Bore	Dimensions inches			KO Size NPT	Weight lb/100	Std. Pkg.
			A	B	C			
3/8"	7STR38B	0.42	1.23	0.59	1.09	3/8"	10	10
1/2"	7STR50B	0.53	1.26	0.59	1.19	1/2"	13	10
3/4"	7STR75B	0.74	1.32	0.59	1.43	3/4"	18	10
1"	7STR100B	0.94	1.75	0.66	1.75	1"	32	5
1-1/4"	7STR125B	1.27	1.76	0.69	2.16	1-1/4"	44	2
1-1/2"	7STR150B	1.48	1.76	0.72	2.38	1-1/2"	66	2
2"	7STR200B	1.92	1.88	0.72	2.88	2"	85	2
2-1/2" *	7STR250B	2.50	3.25	1.50	4.00	2-1/2"	260	1
3" *	7STR300B	3.00	3.88	1.50	4.63	3"	360	1
4" *	7STR400B	4.00	4.00	1.63	5.82	4"	520	1
5" * **	7STR500	5.01	5.00	1.63	7.00	5"	1150	1
6" * **	7STR600	6.01	6.00	-	-	6"	-	1

* Malleable iron body

** 5" & 6" fitting are made in China - non-UL



SEALTITE®
FITTINGS

Trade Size	With Grounding Lug	With Mesh Strain Relief	Min. Int. Bore	Dimensions inches			KO Size NPT	Weight kg(lb)/100	Std. Pkg.
				A	B	C			
3/8"	7STR38BGL	7STR38GT	0.42	1.23	0.59	1.09	3/8"	4.5 (10)	10
1/2"	7STR50BGL	7STR50GT	0.53	1.26	0.59	1.19	1/2"	5.9 (13)	10
3/4"	7STR75BGL	7STR75GT	0.74	1.32	0.59	1.43	3/4"	8.2 (18)	10
1"	7STR100BGL	7STR100GT	0.94	1.72	0.66	1.75	1"	14.5 (32)	5
1-1/4"	7STR125BGL	7STR125GT	1.27	1.76	0.69	2.16	1-1/4"	20 (44)	2
1-1/2"	7STR150BGL	7STR150GT	1.48	1.76	0.72	2.38	1-1/2"	29.9 (66)	2
2"	7STR200BGL	7STR200BGL	1.92	1.88	0.72	2.88	2"	38.6 (85)	2

METALLIC FITTINGS

SEALTITE® FITTINGS ZINC-PLATED STEEL FITTINGS



DESCRIPTION

- Fitting is ideal for use with standard liquid-tight conduit to allow easy installation. IP 66/67 Rated when installed with approved conduit
- Included sealing washer and galvanized steel lock nut provides a means for connecting the fitting to boxes
- Approved for both exposed and concealed locations

SPECIFICATIONS

- Zinc plated steel fitting, has a five piece construction consisting of a gland nut, sealing ring, high tensile grounding ferrule, insulated throat, and body
- Color: Metallic
- Temp. range: -49° F to +221° F (-45° C to + 105° C)
- Complies with UL Standard 514B File No. E472179 category code TEOZ

APPLICATIONS

- Corrosion resistant, protects from moisture and oils
- Suitable for hazardous locations per NEC Articles 501
 - Class I Div. 2, Article 502 Class II
 - Div. 1 & 2, Article 503 Class III Div. 1 & 2

SEALTITE®
FITTINGS

45 DEGREE:



Trade Size	Item ID	Min. Int. Bore	Dimensions inches				KO Size NPT	Weight lb/100	Std. Pkg.
			A	B	C	D			
3/8" *	7STR3845B	0.42	1.00	0.59	1.09	1.06	3/8"	21	10
1/2" *	7STR5045B	0.53	1.00	0.59	1.19	1.25	1/2"	23	10
3/4" *	7STR7545B	0.74	1.13	0.59	1.25	1.31	3/4"	32	10
1" *	7STR10045B	0.94	1.32	0.66	1.75	1.38	1"	53	5
1-1/4" *	7STR12545B	1.27	1.32	0.69	2.16	1.50	1-1/4"	69	2
1-1/2" *	7STR15045B	1.48	1.43	0.7	2.38	1.63	1-1/2"	99	2
2" *	7STR20045B	1.92	1.63	0.72	2.88	1.75	2"	152	2
2-1/2" *	7STR25045B	2.50	4.75	1.50	4.00	2.25	2-1/2"	478	1
3" *	7STR30045B	3.00	5.50	1.50	4.63	2.50	3"	775	1
4" *	7STR40045B	4.00	7.75	1.63	5.81	2.50	4"	1000	1

* Malleable iron body

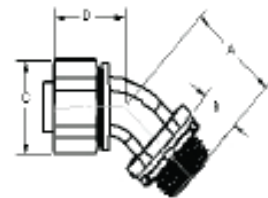

90 DEGREE:



Trade Size	Item ID	Min. Int. Bore	Dimensions inches				KO Size NPT	Weight lb/100	Std. Pkg.
			A	B	C	D			
3/8" *	7STR3890B	0.42	1.13	0.59	1.09	1.25	3/8"	24	10
1/2" *	7STR5090B	0.53	1.13	0.59	1.19	1.44	1/2"	24	10
3/4" *	7STR7590B	0.74	1.50	0.59	1.43	1.56	3/4"	38	10
1" *	7STR10090B	0.94	1.75	0.66	1.75	1.88	1"	70	5
1-1/4" *	7STR12590B	1.27	1.88	0.69	2.16	2.00	1-1/4"	88	2
1-1/2" *	7STR15090B	1.48	2.00	0.72	2.38	2.38	1-1/2"	125	2
2" *	7STR20090B	1.92	2.25	0.72	2.88	2.75	2"	180	2
2-1/2" *	7STR25090B	2.50	8.00	1.50	-	9.25	2-1/2"	625	1
3" *	7STR30090B	3.00	8.75	1.50	-	10.50	3"	900	1
4" *	7STR40090B	4.00	12.63	1.50	-	13.00	4"	1500	1

* Malleable iron body

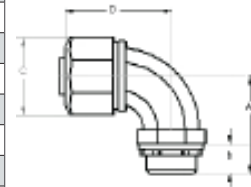

CORD GRIPS

SEALTITE® DOUBLE SEAL CORD GRIPS UL/CSA

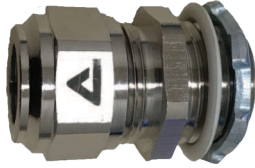

DESCRIPTION

- Contain two clamping seals, one with a larger diameter seal into which a smaller diameter seal fits
- Seals are made of V0 rated EPDM rubber, tested and certified in compliance with EN45545-2, Hazard Level (HL1 / HL2 / HL3) for rail applications
- With larger diameter cable, larger diameter seal can be used on its own
- With smaller diameter cable, both clamping seals required with smaller inserted inside larger
- Both seals supplied as standard
- Double seal glands can also be used with braided cables for EMC applications by simply folding the end of the braid over the top of the clamping seal(s) before mounting
- cULus approved and have extra robust counter nut and an increased clamping strength

SPECIFICATIONS

- Stainless steel gland, male, consisting of 3 parts (body, counter nut and double clamping seal)
- Body and counter nut are stainless steel AISI-316, clamping seals are EPDM rubber
- Color: Metallic
- Temp. range: Temp. range: -49° F to +221° F (-45° C to + 105° C)
- Protection class: IP68, NEMA 4x rated
- cULus Approved # E500099

APPLICATIONS

- Suitable for rail applications HL 1, HL 2 and HL 3 according EN 45545-2, R22 and R23, E15 and E30 according EN 45545-3 for wall and ceiling



SEALTITE®
FITTINGS

STAINLESS STEEL AISI-316



Thread NPT	Item ID	Clamping Range inches		Dimensions inches				Weight lb/100	Std. Pkg.
		S1+S2	S1	A	B	C	E		
1/2" NPT	73871292	0.157 - 0.256	0.256 - 0.335	1.417	0.551	0.669	0.945	10.1	10
1/2" NPT	73871692	0.236 - 0.354	0.354 - 0.472	1.535	0.551	0.866	0.945	11.2	10
3/4" NPT	73871892	0.236 - 0.354	0.354 - 0.472	1.575	0.551	0.866	1.181	15.0	5
3/4" NPT	73872092	0.413 - 0.551	0.551 - 0.669	1.654	0.551	1.063	1.181	16.1	5
1" NPT	73872392	0.413 - 0.551	0.551 - 0.669	1.732	0.630	1.063	1.496	24.0	5
1" NPT	73872692	0.61 - 0.787	0.787 - 0.945	1.811	0.630	1.378	1.496	26.0	5
1-1/4" NPT	73873092	0.61 - 0.787	0.787 - 0.945	1.811	0.630	1.378	1.890	38.6	2
1-1/4" NPT	73873592	0.866 - 1.063	1.063 - 1.220	1.890	0.630	1.693	1.890	40.8	2
1-1/2" NPT	73873892	0.866 - 1.063	1.063 - 1.220	1.969	0.709	1.693	2.165	51.8	2
1-1/2" NPT	73874092	1.161 - 1.378	1.378 - 1.575	2.520	0.709	2.087	2.165	66.1	2

NICKEL PLATED BRASS

Thread NPT	Item ID	Clamping Range inches		Dimensions inches				Weight lb/100	Std. Pkg.
		S1+S2	S1	A	B	C	E		
1/2" NPT	7387122	0.157 - 0.256	0.256 - 0.335	1.417	0.551	0.669	0.945	10.1	10
1/2" NPT	7387162	0.236 - 0.354	0.354 - 0.472	1.535	0.551	0.866	0.945	11.2	10
3/4" NPT	7387182	0.236 - 0.354	0.354 - 0.472	1.575	0.551	0.866	1.181	15.0	5
3/4" NPT	7387202	0.413 - 0.551	0.551 - 0.669	1.654	0.551	1.063	1.181	16.1	5
1" NPT	7387232	0.413 - 0.551	0.551 - 0.669	1.732	0.630	1.063	1.496	24.0	5
1" NPT	7387262	0.61 - 0.787	0.787 - 0.945	1.811	0.630	1.378	1.496	26.0	5
1-1/4" NPT	7387302	0.61 - 0.787	0.787 - 0.945	1.811	0.630	1.378	1.890	38.6	2
1-1/4" NPT	7387352	0.866 - 1.063	1.063 - 1.220	1.890	0.630	1.693	1.890	40.8	2
1-1/2" NPT	7387382	0.866 - 1.063	1.063 - 1.220	1.969	0.709	1.693	2.165	51.8	2
1-1/2" NPT	7387402	1.161 - 1.378	1.378 - 1.575	2.520	0.709	2.087	2.165	66.1	2

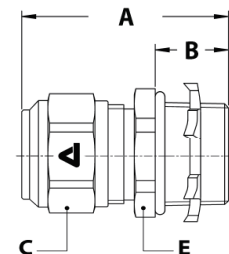

SPECIALTY FITTINGS

ANAMET SPECIALTY ATEX FITTINGS FOR IEC EX EXPLOSION-PROOF AREAS EXPLANATION OF IEC EX-ZONES

ANAMET's ATEX Fittings are based on the European IEC Ex directives.

Care must be taken when applying these to North American installations. Final responsibility of the suitability of the application is up to the customer and the local regulatory standards.

This is a brief explanation and comparison to North American standards.

LOCALIZATION OF GAS A DUST EX-ZONES

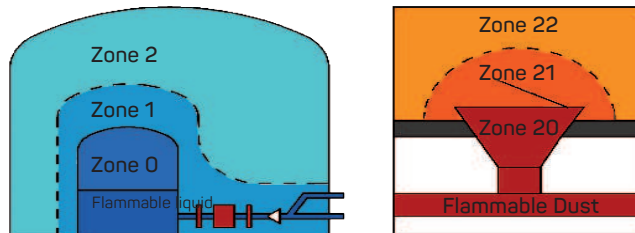

GROUP I - EQUIPMENT FOR USE IN MINING:

Hazardous Atmosphere	Risk	Zone	Category Equipment	ANAMET ATEX System allowed	Security level
Mine Gas, Combustible Dusts	Continuously or for long periods	0	I M1	No	Very high (also safe in case of 2 independent failures)
Mine Gas, Combustible Dusts	Occasionally	1	I M2	Yes	High (also safe in case of 1 failure)

GROUP II - EQUIPMENT FOR USE IN ALL OTHER EXPLOSIVE ATMOSPHERES:

Hazardous Atmosphere	Risk	Zone	Category Equipment	ANAMET ATEX System allowed	Security level
Gases, Vapours and Mists	Continuously or for long periods	0	II 1 G	No	Very high (also safe in case of 2 independent failures)
Gases, Vapours and Mists	Occasionally	1	II 2 G	Yes	High (also safe in case of 1 failure)
Gases, Vapours and Mists	Infrequently or for short periods	2	II 3 G	Yes	Normal (safe during normal functioning)
Dusts	Continuously or for long periods	20	II 1 D	No	Very high (also safe in case of 2 independent failures)
Dusts	Occasionally	21	II 2 D	Yes	High (also safe in case of 1 failure)
Dusts	Infrequently or for short periods	22	II 2 D II 3 G	Yes Yes	High (conducting Dusts) Normal (non-conducting Dusts)

DIFFERENCES BETWEEN EUROPEAN AND NORTH AMERICAN STANDARDS:

Region	Constant presence risk	Occasional presence risk	Presence risk only in case of failure
IEC/Europe	Zone 0	Zone 1	Zone 2
U.S./Canada	Division I		Division II

SPECIALTY FITTINGS

SEALTITE® ATEX FITTINGS STAINLESS STEEL AISI-316 NPT/METRIC FITTINGS



SPECIFICATIONS

- AISI-316 Stainless Steel with PTFE clamping ring.
- Separate 2 compound epoxy provided for creating barrier.
- Color: Metallic
- Temp. range: -76°F to 266°F (-60°C to 130°C)
- IECEx-ATEX certified:
CE0080 I M2 / II 2 GD / Ex d II C / Ex e II / Ex d I /
Ex tD A 21 IP66

APPLICATIONS

- Metallic and Type B non-metallic flexible conduit
- Explosion-proof areas where Zone system used
- Machinery for export to other countries where Zone system used
- Superior corrosion resistance with 316 Stainless

DESCRIPTION

- Explosion Proof fittings for any SEALTITE® conduit (except CNP)
- IECEx-ATEX approved barrier fittings to provide seal around loose wires inside a SEALTITE® conduit
- Barrier around loose wires created through a bi-compound epoxy sealing supplied with the fitting
- IP67 on the conduit and IP66 between fitting and switchbox
- Excellent corrosion resistance with AISI-316 Stainless Steel

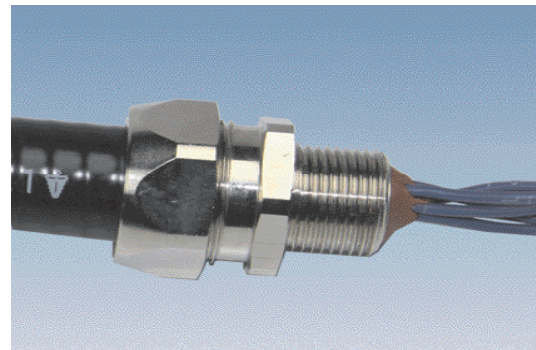

SEALTITE®
FITTINGS

BARRIER BX A NPT:



Trade Size	Item ID	Min. Int. Bore (mm)	Dimensions inches				KO Size NPT	Weight lb/100	Std. Pkg.
			A	B	C	E			
1/2"	8370169	13.8	1.457	0.512	1.024	1.063	1/2"	24.7	10
3/4"	8370209	18.5	1.457	0.512	1.142	1.299	3/4"	33.7	5
1"	8370269	23.8	1.575	0.591	1.379	1.732	1"	59.3	5
1-1/4"	8370359	31.9	1.811	0.591	1.772	2.047	1-1/4"	89.9	2

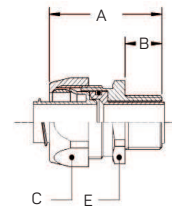



NON-METALLIC SEALTITE® SERIES

ANACONDA SEALTITE® is available in non-metallic, manufactured to the same high standard to meet industry requirements.

SEALTITE® fittings appropriate for these conduits are included with the catalogue pages as the fittings are unique to the conduits.



NON-METALLIC SEALTITE® SERIES

SEALTITE® CNP (TYPE A) NON-METALLIC FLEXIBLE CONDUIT



DESCRIPTION

- Non-metallic Type A liquid-tight conduit
- Great for constantly flexing applications
- Good for abrasion and where physical abuse may exist
- Standard in orange
- Also available in Gray
- Uses Type A Connector only

COMMON NEC Articles

- 300.22 (C) Other spaces used for Environmental Air (Plenums)
- 501.10 (B) (2) Class I Div. 2; 502.10 (A) (2) and (B) (2) Class II Dive 1 & 2; 503.10 (A) (3) and (B) Class III Div. 1 & 2
- 356 Liquid-tight Flexible Nonmetal Conduit (LFNC-A)

SPECIFICATIONS

- Smooth inner PVC core with outer oil resistant PVC cover bonded together with nylon reinforcing braid
- Color: Orange
- Temperature range: -4°F to +140°F (-20°C to 60°C)
- UV (sunlight) resistant, Flame retardant
- Oil resistant
- UL Approved #E75863
- CSA Approved #LL15275-10

APPLICATIONS

- Automotive applications requiring continuous flexing
- Food machine applications where non-metallic and flexing required



Trade Size (mm)	Item ID	Std. Pkg. ft	Inside Diameter		Outside Diameter		Bend Radius	Weight lbs/cft
			Min	Max	Min	Max		
3/8" (12)	38602	100	0.485	0.505	0.755	0.775	2.5	15
	38604	800						
	38601	250						
1/2" (16)	38612	100	0.620	0.640	0.910	0.930	3.0	21
	38611	200						
	38614	500						
3/4" (21)	38622	100	0.815	0.835	1.150	1.170	4.0	30
	38621	150						
	38624	400						
1" (27)	38631	100	1.030	1.055	1.415	1.440	6.0	43
	38634	300						
1-1/4" (35)	38641	50	1.370	1.395	1.800	1.825	7.0	58
	38643	200						
1-1/2" (41)	38651	50	1.585	1.620	2.045	2.080	7.0	81
	38653	100						
2" (53)	38661	50	2.045	2.080	2.605	2.640	9.0	122
	38663	100						

NON-METALLIC SEALTITE®

FITTINGS FINDER



PAGE 44

NON-METALLIC SEALTITE® SERIES

TYPE A FITTINGS FITTINGS FOR CNP TYPE A CONDUIT (ONLY)

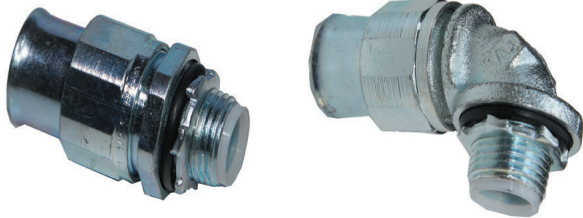

SPECIFICATIONS

- Zinc plated steel, 3-piece
- Color: Metallic
- UL approved File No. E472179
- CSA Approved #065178
- Includes sealing ring, galvanized nut required to connect fitting to box
- Corrosion resistance, strength, durability
- 49°F to 221°F (-45°C to 105°C)

DESCRIPTION

- STMN Series liquid tight connectors only approved for use with SEALTITE® CNP flexible conduit

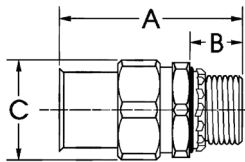

STRAIGHT



Trade Size	Item ID	Dimensions inches			KO Size NPT	Weight lb/Pkg	Std. Pkg.
		A	B	C			
3/8"	STNM38	2.156	0.594	1.156	1/2"	5.6	25
1/2"	STNM50	2.594	0.594	1.313	1/2"	8.1	25
3/4"	STNM75	2.594	0.594	1.625	3/4"	11.0	25
1"	STNM100	2.875	0.719	1.938	1"	3.2	5
1-1/4"	STNM125	3.406	0.750	2.406	1-1/4"	6.0	5
1-1/2"	STNM150	3.438	0.750	2.781	1-1/2"	3.0	2
2"	STNM200	3.969	0.750	3.375	2"	2.4	1

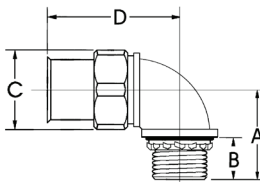

90 DEGREE



Trade Size	Item ID	Dimensions inches				KO Size NPT	Weight lb/Pkg	Std. Pkg.
		A	B	C	D			
3/8"	STNM9038	1.25	0.594	1.156	2.03	1/2"	7.5	25
1/2"	STNM9050	1.28	0.594	1.313	2.38	1/2"	9.5	25
3/4"	STNM9075	1.44	0.594	1.625	2.5	3/4"	5.5	10
1"	STNM90100	1.75	0.719	1.938	2.75	1"	4.1	5
1-1/4"	STNM90125	1.97	0.750	2.406	3.47	1-1/4"	7.7	5
1-1/2"	STNM90150	2.25	0.750	2.781	3.59	1-1/2"	4.0	2
2"	STNM90200	2.53	0.750	3.375	4.41	2"	3.1	1

NON-METALLIC SEALTITE® SERIES

SEALTITE® NMUA (TYPE B) NON-METALLIC FLEXIBLE CONDUIT

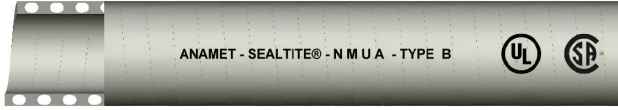

DESCRIPTION

- Non-metallic Type B liquid-tight conduit
- Designed for standard commercial and industrial applications
- Approved in US (per NEC) for direct burial applications
- Also available by special order in other colours (consult factory)
- Uses special non-metallic connectors for easy installation. Can also be used with standard liquid-tight connector
- Available in custom cut lengths

COMMON NEC Articles

- 300.22 (C) Other spaces used for Environmental Air (Plenums)
- 501.10 (B) (2) Class I Div. 2; 502.10 (A) (2) and (B) (2) Class II Dive 1 & 2; 503.10 (A) (3) and (B) Class III Div. 1 & 2
- 356 Liquid-tight Flexible Nonmetal Conduit (LFNC-B)

SPECIFICATIONS

- Co-extruded PVC conduit
- Color: Gray
- Temp. range: -17°F to +176°F (-27°C to +80°C)
- UV (sunlight) resistant
- Oil resistant
- UL Approved #E211327
- CSA Approved #20817

APPLICATIONS

- HVAC industry
- Commercial and industrial applications requiring UL & CSA approvals

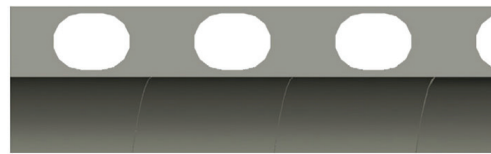

Rigid PVC Reinforced 3/8" through 2"



Trade Size (mm)	Item ID	Std. Pkg. ft	Inside Diameter		Outside Diameter		Bend Radius	Weight lbs/cft
			Min	Max	Min	Max		
3/8" (12)	39702	100	0.484	0.504	0.690	0.710	2.0	11
	39708	1000						
1/2" (16)	39712	100	0.622	0.640	0.820	0.840	3.3	15
	39713	1000						
3/4" (21)	39722	100	0.820	0.840	1.030	1.050	4.5	20
	39724	700						
1" (27)	39731	100	1.041	1.066	1.290	1.3150	6.5	27
	39734	500						
1-1/4" (35)	39741	50	1.380	1.410	1.630	1.660	8.0	36
	39742	100						
1-1/2" (41)	39753	50	1.575	1.600	1.865	1.900	9.0	45
	39752	100						
2" (53)	39761	50	2.020	2.045	2.340	2.375	11.1	67
	39768	100						



NON-METALLIC SEALTITE® SERIES

SEALTITE® NMEF (TYPE B) NON-METALLIC FLEXIBLE TUBING



DESCRIPTION

- Non-metallic Type B liquid-tight tubing
- Designed for OEM and industrial applications
- Uses special non-metallic connectors for easy installation. Can also be used with standard liquid-tight connector
- Available in custom cut lengths

SPECIFICATIONS

- Co-extruded PVC conduit
- Extra flexible
- Color: Black
- Temp. range: -17°F to +176°F (-27°C to +80°C)
- UV (sunlight) resistant
- Oil resistant
- CSA Approved

APPLICATIONS

- OEM machine building
- Industrial applications where tight bend radius is required



Co-extruded special with smooth inner wall

NON-METALLIC
SEALTITE®



Trade Size (mm)	Item ID	Std. Pkg. ft	Inside Diameter		Outside Diameter		Bend Radius	Weight lbs/cft
			Min	Max	Min	Max		
3/8" (12)	3620120	100	0.484	0.504	0.690	0.710	0.8	9
1/2" (16)	3620160	100	0.622	0.640	0.820	0.840	0.9	11
3/4" (21)	3620200	100	0.820	0.840	1.030	1.050	1.0	13
1" (27)	3620260	100	1.041	1.066	1.290	1.315	1.4	20
1-1/4" (35)	3620350	50	1.380	1.410	1.630	1.660	1.7	22
1-1/2" (41)	3620400	50	1.575	1.600	1.865	1.900	2.0	27
2" (53)	3620500	50	2.020	2.045	2.340	2.375	8.0	45

FITTINGS FINDER



PAGE 47

NON-METALLIC SEALTITE® SERIES

NON-METALLIC FITTINGS FITTINGS FOR NMUA/NMEF TYPE B ONLY

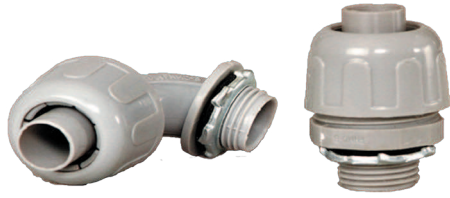

SPECIFICATIONS

- Color: Gray
- Temp. range: Dry: -18°C to +90°C (0°F to +194°F)
- UV (sunlight) resistant
- UL Approved File No. E322120
- CSA Approved #620817

DESCRIPTION

- All type nylon 66 construction with “O” ring and steel lock nut included.
- Reusable and durable fittings are flame retardant and resist salt water, weak acids, gasoline, alcohol, oil grease, and common solvents.

INSTALLATION

- Fittings used with standard non-metallic **Type B** conduit for easy installation.
- Approved for both exposed and concealed locations.
- Easy to install, by pushing the non-metallic conduit onto the smooth ferrule and tightening the sealing nut.
- Manufactured in a full range of trade sizes from 3/8” through 2”.
- Complies with NEC Article 356 and UL Standard 514B File No. E-322120.
- Straight fittings approved for direct burial and in concrete trade sizes 3/8” through 2”.

COMMON NEC Articles

- Article 250.102 Equipment Bonding Jumpers
- Article 250.134 (B) Equipment Grounding
- Article 356 Liquid-Tight Flexible Nonmetallic Conduit (LFNC-B)
- Article 501.10 (B) (2) Class I Div. 2
- Article 502.10 (A) (2) and (B) (2) Class II Div. 1 & 2
- Article 503.10 (A) (3) and (B) Class III Div. 1 & 2
- Article 620.21 Elevator Wiring Methods
- Article 645.5 (E) (2) Under Raised Floors

3 PIECE:

STRAIGHT



Trade Size	Item ID	Dimensions inches			KO Size NPT	Weight lb/Pkg	Std. Pkg.
		A	B	C			
3/8"	500001	1.545	0.535	1.400	1/2"	1.25	25
1/2"	500002	1.545	0.535	1.400	1/2"	1.25	25
3/4"	500003	1.600	0.550	1.700	3/4"	0.7	10
1"	500004	1.975	0.670	2.000	1"	0.7	5
1-1/4"	500005	2.293	0.645	2.400	1-1/4"	1	5
1-1/2"	500006	2.175	0.660	2.670	1-1/2"	0.6	5
2"	500007	2.400	0.670	3.280	2"	0.8	2

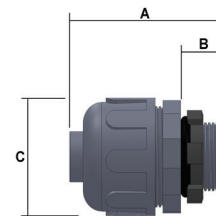

90 DEGREE

Trade Size	Item ID	Dimensions inches			KO Size NPT	Weight lb/Pkg	Std. Pkg.
		A	B	C			
3/8"	500008	2.242	0.562	3.120	1/2"	0.5	10
1/2"	500009	2.242	0.562	3.120	1/2"	0.5	10
3/4"	500010	2.550	0.545	3.600	3/4"	1	10
1"	500011	3.150	0.630	4.125	1"	0.8	5
1-1/4"	500012	3.420	0.645	5.200	1-1/4"	1.4	2
1-1/2"	500013	4.510	0.660	5.200	1-1/2"	0.8	2
2"	500014	4.850	0.670	5.800	2"	1	1

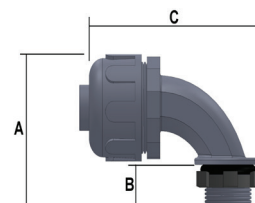

NON-METALLIC SEALTITE®



FIRETECH FIRE PROTECTIVE PRODUCTS

FIRETECH solutions offer protection for cables and wires as well as hydraulic or air lines against various sources of intense heat. Depending on your industry and the application you require, these will withstand high temperatures, flames, molten splash, sparks, thermal attacks or aggressive chemicals.

The product range includes FIRETECH Sleeve, Wrap and Sheet products, able to withstand continuous temperatures up to +500°F continuous and +2000°F intermittently. Select the fitting type you require and the size of sleeve it must be compatible with to narrow down the selection and find the solution you are looking for.

FIRE PROTECTIVE PRODUCTS

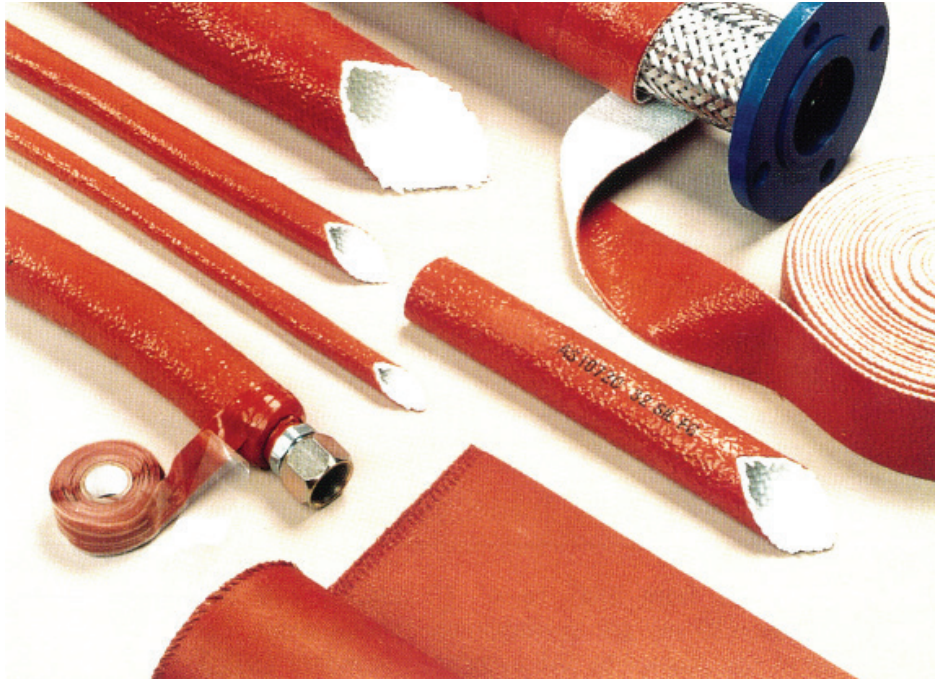

FIRETECH SLEEVE/WRAP/TAPE/BLANKET:

- Flexible sleeving for protection of cables from high heat or flame
- Silicone based cover over a knitted fiberglass sleeve
- Superior temperature range for extreme environments
- Abrasion resistant—Ready for the worst environment
- The ultimate protection for harsh industrial applications
- Sleeve is UL Recognized



FIRETECH VCO:

- Any of the standard FIRETECH Sleeves can be slit and sewn with a high temperature hook-and-loop closure. This allows easy assembly and removal without disconnecting cables
- Custom made. Consult factory for details



FIRETECH FITTINGS:

- ANAMET Stainless Steel fittings for FIRETECH come with a special internal collar to allow the FIRETECH Sleeve to be held firmly, creating a method of sealing the ends of the sleeve that is stronger than tape
- Allows interconnect into standard NPT applications and provides a cleaner finished installation

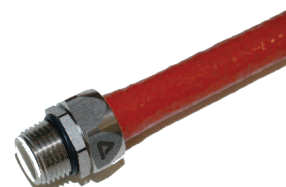

FIRETECH

FIRETECH SLEEVE



DESCRIPTION

- Solid braided fiberglass sleeving, with thick silicone cover
- Superior short-term flame protection and excellent temperature reduction
- Resistant to hydraulic fluids, lubricating oils and fuels
- Protects against molten splash, occasional flames, heat radiation, energy loss in piping and hoses
- Protects workers from burns

FIRETECH SLEEVE:

Item ID	Inside Diameter	Std. Pkg. ft	Weight lbs/cft
205162	5/16"	100	7.9
205161	5/16"	50	4.0
200382	3/8"	100	9.9
200381	3/8"	50	5.0
207162	7/16"	100	11.0
207161	7/16"	50	5.5
200122	1/2"	100	13.0
200121	1/2"	50	6.5
200582	5/8"	100	14.1
200581	5/8"	50	7.1
200342	3/4"	100	17.0
200341	3/4"	50	8.5
200782	7/8"	100	18.1
200781	7/8"	50	9.0
200102	1"	100	20.9
200101	1"	50	10.5
201182	1-1/8"	100	22.1
201181	1-1/8"	50	11.0
201142	1-1/4"	100	26.0
201141	1-1/4"	50	13.0
201382	1-3/8"	100	30.0

SPECIFICATIONS

- Silicone over braided fiberglass sleeve
- cURus Recognized
- Color: Orange
- Temp. range:
 - 500°F (+260°C) continuous,
 - 2000°F (+1090°C) for 15-20 min.
 - 3000°F (+1650°C) for 15-30 sec.
- UL Recognized for US and Canada #E321462 (Sleeve only)

APPLICATIONS

- Extreme duty applications
- Extreme heat or flame

Item ID	Inside Diameter	Std. Pkg. ft	Weight lbs/cft
201381	1-3/8"	50	15.0
201122	1-1/2"	100	34.2
201121	1-1/2"	50	17.1
201582	1-5/8"	100	35.1
201581	1-5/8"	50	17.5
201342	1-3/4"	100	36.2
201341	1-3/4"	50	18.1
200202	2"	100	40.1
200201	2"	50	20.1
202142	2-1/4"	100	43.0
202141	2-1/4"	50	21.5
202122	2-1/2"	100	46.1
202121	2-1/2"	50	23.0
202342	2-3/4"	100	51.2
202341	2-3/4"	50	25.6
200302	3"	100	58.2
200301	3"	50	29.1
203142	3-1/4"	100	69.2
203141	3-1/4"	50	34.6
203122	3-1/2"	100	72.1
203121	3-1/2"	50	36.1
203342	3-3/4"	100	74.1
203341	3-3/4"	50	37.0
200402	4"	100	77.2
200401	4"	50	38.6

FIRETECH

FIRETECH WRAP



DESCRIPTION

- Solid braided fiberglass sleeving, with thick silicone cover
- Superior short-term flame protection and excellent temperature reduction
- Resistant to hydraulic fluids, lubricating oils and fuels
- Protects against molten splash, occasional flames, heat radiation, energy loss in piping and hoses
- Protects workers from burns

SPECIFICATIONS

- Silicone over braided fiberglass sleeve
- cURus Recognized
- Color: Orange
- Temp. range:
 - 500°F (+260°C) continuous,
 - 2000°F (+1090°C) for 15-20 min.
 - 3000°F (+1650°C) for 15-30 sec.
- UL Recognized for US and Canada #E321462 (Sleeve only)

APPLICATIONS

- Extreme duty applications
- Extreme heat or flame

FIRETECH WRAP:

Item ID	Inside Diameter	Std. Pkg. ft	Weight lbs/cft
240012	1"	100	21
240022	2"	100	40
240032	3"	100	59
240042	4"	100	78
240052	5"	100	97



FIRETECH

FIRETECH BLANKET



DESCRIPTION

- FireTech is the ultimate heat protection for cables
- Solid braided fiberglass sleeving, with thick silicone cover
- Superior short-term flame protection and excellent temperature reduction
- Resistant to hydraulic fluids, lubricating oils and fuels
- Protects against molten splash, occasional flames, heat radiation, energy loss in piping and hoses
- Protects workers from burns

SPECIFICATIONS

- Silicone over fiberglass sheet
- Color: Orange
- Temp. range:
 - +260°C (500°F) continuous,
 - +1090°C (2000°F) for 15-20 min.
 - +1650°C (3000°F) for 15-30 sec.

APPLICATIONS

- Extreme duty applications
- Extreme heat or flame

FIRETECH BLANKET:



Item ID	Size	Std. Pkg. ft	Weight lb per pkg
220036	36" 2 sides	Cut-to-length	0.8
220040	40" 1 side	Cut-to-length	1.3
220060	60" 2 sides	Cut-to-length	2.0



FIRETECH

FIRETECH TAPE



SPECIFICATIONS

- Silicone over fibreglass sheet
- Color: Orange
- Temperature: 475°F (+246°C) max.

APPLICATIONS

- Extreme duty applications
- Extreme heat or flame

DESCRIPTION

- FireTech is the ultimate heat protection for cables
- Solid braided glass fibre sleeving, with thick silicone cover
- Superior short-term flame protection and excellent temperature reduction
- Resistant to hydraulic fluids, lubricating oils and fuels
- Protects against molten splash, occasional flames, heat radiation, energy loss in piping and hoses
- Protects workers from burns

FIRETECH TAPE:



Item ID	W x L x Thickness	Weight lb	Std. Pkg.
231002	1" x 432" x .020" (25.4 x 10.9m x 0.51mm)	0.31	Per roll
231126	1-1/2" x 432" x .060" (38.1mm x 10.9m x 1.52mm)	0.99	Per roll



APPENDIX

CONDUIT CUTTING INSTRUCTIONS

Standard and Small Cartons



Standard coils of Anaconda SEALTITE® are packaged in handy, strong, corrugated cartons. These cartons keep stock clean and are easy to handle, stack and identify. Size, type, color and footage are prominently displayed on the side of each carton. A handy cutting instruction card is included in each carton.

Smaller coils of Anaconda SEALTITE® types EF, EFST and UA are also packaged in corrugated cartons with the same features as the standard coil cartons mentioned above. Smaller coils provide the same convenience as standard coils—the shorter length allow for more economical purchasing on the smaller jobs.

Non-returnable Standard and Small Wooden Reels



Anaconda SEALTITE® is available on non-returnable wooden reels at no extra cost. Continuous lengths on reels eliminates scrap and special handling.

For those who like the convenience of reels, but do not require the longer footages on the standard reels, Anamet offers smaller reels with less continuous footage on types EF, EFST, CW, UA and ZHUA conduit.

Electrical Trade Size (Inches)	Flange (Inches)	Traverse* (Inches)	Core Diameter (Inches)	Center Hole (Inches)
Standard	Reel	Dimensions		
3/8 and 1/2	30	18	10	2
3/4	36	26	20	2
1 and 1-1/4	30	22	14-1/2	2
Small	Reel	Dimensions		
3/8, 1/2	24	18	13	2
3/4, 1-1/2 & 2	30	17	14-1/2	2

*Measurement Between Flanges

Large Reels Available on Special Request

Hand Cutting SEALTITE® with Metallic Core

Importance of clean, square cut:

- Easier fitting attachment.
- Conduit makes full contact with base of liquid-tight fitting.
- Gives greater holding power to fitting.
- Assures a liquid-tight assembly throughout.

Non-metallic SEALTITE®

- Square, clean cuts are important for effective assembly with electrical fittings. Conduit is marked at approx 12" intervals for easy measuring.
- Type CNP conduit can be cut most easily with a sharpened "parrot nosed" electrical cable slicer.
- Good clean cuts can also be made with a sharp shoe knife. A little liquid detergent used to "wet" the knife blade will reduce frictional drag appreciably.
- Cutting the non-metallic conduit with a saw is not recommended.

Production Cutting SEALTITE® Using a Band Saw

When cutting Anaconda SEALTITE® with a band saw, the recommended blade specifications are: 1/2" wide x .025" thick, having 24 teeth per inch, no set. Blade speed should be approximately 350 ft. per minute. Band Saw cutting is recommended when extensive cutting is required. Do NOT use abrasive wheel.

Custom Cut Lengths

- Size range 1/8" to 2"
- Lengths up to 12 feet

Quotations available upon request.

Anamet Electrical Standard Cut Length Tolerances

EXTENDED CUT LENGTHS			TOLERANCES	
OVER		TO	PLUS	MINUS
"-----		"-----		
0 IN	THRU	8 IN	1/4 IN	0
8 IN	THRU	18 IN	3/8 IN	0
18 IN	THRU	3 FT	3/4 IN	0
3 FT	THRU	6 FT	1-1/2 IN	0
6 FT	THRU	12 FT	3 IN	0
12 FT	THRU	20 FT	8 IN	0
20 FT	THRU	49 FT	1 FT	0
49 FT	AND	UP	2 FT	0

Notes:

- 1 - This chart applies if no tolerances appear on drawing or factory orders.
- 2 - This chart does not apply to product when it is to be cut in the "Normal Lie" position.

APPENDIX

CHEMICAL RESISTANCE

The following chart gives a guideline of chemical resistance of PVC jacketed conduits.

Rating System:
1 - Excellent 2 - Good 3 - Fair 4 - Poor

Chemical	Resistance	Chemical	Resistance	Chemical	Resistance
Acetate Solvents	4	Creosote	4	Methyl Acetate	4
Acetic Acid (10%)	2	Cresol	3	Methyl Alcohol	3
Acetic Acid (Glacial)	3	Cresylic Acid	4	Methyl Bromide	4
Acetone	4	Cyclohexane	2	Methyl Ethyl Ketone	4
Acrylonitrile	1	DDT Weed Killer	1	Methylene Chloride	4
Alcohols (Aliphatic)	3	Dibutyl Phthalate	4	Mineral Oil	1
Aluminum Chloride	1	Diesel Oils	3	Monochlorobenzene	4
Aluminum Sulfate (Alums)	1	Diethylene Glycol	2	Muriatic Acid (see Hydrochloric Acid)	-
Ammonia (Anhydrous Liquids)	4	Diethyl Ether	1	Naphtha	3
Ammonia (Aqueous)	1	Di-isodecyl Phthalate	4	Naphthalene	4
Ammoniated Latex	1	Diocetyl Phthalate	4	Nitric Acid (10%)	1
Ammonium Chloride	1	Dow General Weed Killer (Phenol)	4	Nitric Acid (35%)	1
Ammonium Hydroxide	1	Dow General Weed Killer(H2O)	2	Nitric Acid (70%)	4
Amyl Acetate	4	Ethyl Alcohol	3	Oleic Acid	1
Aniline Oils	4	Ethylene Dichloride	4	Oleum	4
Aromatic Hydrocarbons	4	Ethylene Glycol	2	Oxalic Acid	1
Asphalt	4	Ferric Chloride	1	Pentachlorophenol in Oil	2
ASTM Fuel A	3	Ferric Sulphate	1	Pentane	3
ASTM Fuel B	4	Ferrous Chloride	1	Perchloroethylene	4
ASTM #1 Oil	2	Ferrous Sulphate	1	Petroleum Ether	3
ASTM #3 Oil	3	Formaldehyde	4	Phenol	2
Barium Chloride	1	Fuel Oil	2	Phosphoric Acid (85%)	1
Barium Sulphide	1	Furfural	3	Pitch	2
Barium Hydroxide	1	Gallic Acid	1	Potassium Hydroxide	1
Benzene (Benzol)	4	Gasoline (HI test)	3	Propyl Alcohol	2
Benzine (Petroleum Ether)	3	Glycerine	1	Ritchfield "A" Weed Killer	3
Black Liquor	1	Grease	1	Sea Water	1
Bordeaux Mixture	1	Green Sulphate Liquor	1	Sodium Hydroxide (10%)	1
Boric Acid	1	Heptachlor in Petroleum Solvents	1	Sodium Hydroxide (50%)	1
Butyl Acetate	4	Heptane	3	Soybean Oil	3
Butyl Alcohol	2	Hexane	3	Sodium Cyanide	1
Calcium Hydroxide	1	Hydrobromic Acid	1	Stoddard Solvent	4
Calcium Hypochloride	1	Hydrochloric Acid (10%)	1	Styrene	4
Carbolic Acid (Phenol)	2	Hydrochloric Acid (40%)	3	Sulphur Dioxide (liquid)	4
Carbon Dioxide	1	Hydrochloric Acid (70%)	4	Sulphuric Acid (50%)	1
Carbon Disulphide	4	Hydrofluorobonic Acid	1	Sulphuric Acid (98%)	4
Carbon Tetrachloride	4	Hydrofluorosilicic Acid	1	Sulphurous Acid	2
Carbonic Acid	1	Hydrogen Peroxide (10%)	1	Tall Oil	4
Casein	1	Iso-octane	3	Tannic Acid	1
Caustic Soda	1	Isopropyl Acetate	4	Toluene	4
Chlorine Gas (wet)	4	Isopropyl Acetate	2	Trichlorethylene	4
Chlorine Gas (dry)	4	Jet Fuels (JP-3, 4 and 5)	3	Triethanol Amine	3
Chlorine (water solution)	3	Kerosene	3	Tricresyl Phosphate (Skydrol)	4
Chlorobenzene	4	Ketones	4	Turpentine	3
Chlorinated Hydrocarbons	4	Linseed Oil	1	Vinegar	1
Chromic Acid (10%)	2	Lubricating Oils	1	Vinyl Chloride	4
Citric Acid	1	Magnesium Chloride	1	Water	1
Coal Tar	4	Magnesium Hydroxide	1	White Liquor	1
Coconut Oil	3	Magnesium Sulphate	1	Xylene	4
Corn Oil	1	Malathion 50 in Aromatics	4	Zinc Chloride	1
Cottonseed Oil	3	Malic Acid	1	Zinc Sulphate	1

PRODUCT COMPARISON CHART

ANAMET Electrical, Inc. Sealtite®	Electriflex Company Liquatite	Southwire	International Metal Hose Sealed Skin	Alflex Corp. Ultratite	AFC Cable Systems Liquid-Tuff™	Kaf-Tech	Superflex	Carlton
UA/CSA 3/8-4" UL Listed/ CSA certified	LA 3/8-4" UL Listed CSA Certified	UL 3/8-4" UL Listed	UALT 3/8-4" UL Listed UL & CSA	UL 3/8-4" UL Listed CSA Certified	UL 3/8-4" UL Listed CSA Certified	UL 3/8-4" UL Listed CSA Certified	-----	-----
EFST 1/4-6" Extra Flex	LT 1/4-6" JIC	-----	JIC 3/8-5" Extra Flex	-----	VF 3/8-4" Extra Flex / JIC	VF 3/8-4" Extra Flex / JIC	-----	-----
EF 3/8-2"	EF 3/8-2" Extra Flex	EF 3/8-4" Extra Flex / JIC	EFLT 3/8-4" Contractor Grade	EF 3/8-4"	-----	-----	-----	-----
EFL 3/8-4" Aluminum	ALT 3/8-6"	LEF 3/8-4"	-----	AEF 3/8-4"	-----	-----	-----	-----
CSA Same as UA Dual Listed	CSA 3/8-4" CSA only	CSA 3/8-4" CSA	CSALT 3/8-4" UL & CSA	-----	-----	-----	-----	-----
HC 3/8-4" Hot-Cold -46°C+105°C	-----	HTC 3/8-4"	HLT 3/8-5" Hot-Cold -40°C+105°C	-----	-----	-----	-----	-----
HCSS 3/8-4" Hot-Cold / 316SS -46°C+105°C	ATSS 3/8-4" Hot-Cold / 316SS	-----	-----	-----	-----	-----	-----	-----
OR 3/8-4" Oil-Resistant	LOR 3/8-6" Oil-Resistant	SOR 3/8-4" Oil-Resistant	OR 3/8-5" Oil-Resistant	OR 3/8-4" Oil-Resistant	OR 3/8-4" Oil-Resistant	OR 3/8-4" Oil-Resistant	-----	-----
CW 1/2-3" Computer Wiring UL & CSA	LA Blue 3/8-4" Computer Wiring UL & CSA	COM 3/8-4" Computer Conduit UL & CSA	CBLT 3/8-4" Computer Conduit UL & CSA	CB 3/8-4" Computer Blue UL & CSA	Computer Blue 3/8-4" UL Listed CSA Certified	Computer Blue 3/8-4" UL Listed CSA Certified	-----	-----
HGX 3/8-4" High Temp. -60°C+150°C	ATX 3/8-4" High Temp. -17°C+105°C	SPEC-FLEX 3/8-4" High temp -51°C+135°C	-----	-----	Extreme Temp 3/8-4" -60°C+135°C	Extreme Temp 3/8-4" -60°C+135°C	-----	-----
ZHUA 3/8-4" Zero Halogen UL	ZHLA 3/8-4" Non-Halogen UL	SAF-T-FLEX 3/8-3" UL & CSA	-----	-----	LSZH 3/8-2-1/2" Zero Halogen UL	LSZH 3/8-2-1/2" Zero Halogen UL	-----	-----
HFSS 3/8-4" 316 SS Zero Halogen	ZHSS 3/8-4" 316 SS Zero Halogen	-----	-----	-----	-----	-----	-----	-----
Shieldtite® 3/8-4" Special Shielding Conduit	EMS 3/8-4" Shielding Conduit	-----	-----	-----	-----	-----	-----	-----
HTUA 3/8-4" -46°C+105°C UL & CSA	ATLA 3/8-4" Hot-Cold -55°C+105°C	Titan HC 3/8-4" Hot-Cold -40°C+105°C	-----	Hi-Low 3/8-4" -40°C+105°C UL & CSA	Hi-Low 3/8-4" -40°C+105°C UL	Hi-Low 3/8-4" -40°C+105°C UL	-----	-----
MTC 3/8-2" -20°C+60°C	VJC 3/8-2" -20°C+80°C	MTLT 3/8-2" -40°C+90°C	-----	-----	-----	-----	-----	-----
CNP 3/8-2" UL & CSA	LNM-P 3/8-2" UL & CSA	ONP 3/8-2" UL & CSA	-----	-----	LFNC-A 3/8-2" UL & CSA	LFNC-A 3/8-2" UL & CSA	-----	-----
NMUA 3/8-2" UL & CSA	NM 3/8-2" UL & CSA	DURAFLEX 3/8-2" UL & CSA	NMUA 3/8-2" UL	NM 3/8-2" UL & CSA	LFNC-B 3/8-2" UL & CSA	LFNC-B 3/8-2" UL & CSA	Sealproof-B 3/8-2" UL & CSA	CARFLEX 3/8-2" UL Listed
Greenfield 3/8-4" RWA/RWS Aluminum, Steel UL	BR / ABR 3/8-4" RW Steel, Aluminum UL	GFAU & GFSU 3/8-4" Aluminum, Steel UL	RWA RWS 3/8-4" R-W Steel, Aluminum UL	5/16-4" R-W Steel, Aluminum UL	3/8-4" R-W Steel, Aluminum UL	3/8-4" R-W Steel, Aluminum UL	-----	-----
DSL 3/16-3/4" Non-liquid-tight Extra Flex	SL 3/16-1" Non-liquid-tight	-----	SF 3/16-2" Non-liquid-tight Extra Flex	-----	-----	-----	-----	-----
DE-710 5/16-3/4" Non-liquid-tight Recognized RU	USL 5/16-3/4" Non-liquid-tight Recognized RU	-----	AFS 5/16-3/4" Non-liquid-tight Recognized RU	-----	-----	-----	-----	-----

Our Commitment

Anamet Electrical, Inc. is committed to always meet or exceed our customers' expectations.

Services for Wiring Conduit Products

Cutting to length

Anamet has a cut length department with the experience and capabilities to meet all your design requirements. Whether you require small or large volumes or tight tolerances, we will meet your requests.

Deburring

When flexible metal conduit is cut, sharp edges and burrs remain. Anamet has several deburring machines that remove the sharp edges which can impede assembly or installation.

Burnishing

This process improves the appearance of stripwound stainless steel from a dull scratched appearance to a bright shiny mirrored finish.

Customer specific marking on covered products

Anamet can print custom text and small company or product logos on to the exterior of liquid tight flexible products.

Passivation

Passivation is the removal of iron compounds from the surface of stainless steel by means of a chemical dissolution that will remove the surface contamination but will not significantly affect the stainless steel itself.

Braiding

A flexible, tubular, metal sheath consisting of interwoven strands of wire. The primary purposes are to improve torque resistance and shielding.

Color matching

Anamet currently stocks many standard colors and we have the ability to match any Pantone color. This is an excellent way to improve brand recognition, product designation or to designate voltage.

Special liquid tight covers

Anamet offers a large variety of PVC, TPR, TPU, FEP and Silicone liquid tight covers. No matter how complicated your specifications might be, Anamet will accommodate your requirements.

Tools Available Online at www.anacondasealtite.com

- Installation Instructions
- Chemical Resistance Chart
- NEMA Bulletins

Anamet Electrical offers a 3 business day commitment on non-standard price requests.

Contact Us

Anamet Electrical, Inc.

1000 Broadway Ave. East
Mattoon, IL 61938

Customer Service: (800) 230-3718

Fax: (800) 677-2706

Email: info@anametelectrical.com

Office hours: 7:00 am - 5:00 pm CST - Monday-Friday

Find us on the web! Visit www.anacondasealtite.com





100 YEARS
OF FLEXIBLE
SAFETY

ANAMET ELECTRICAL, INC.
1000 BROADWAY AVE EAST
MATTOON, IL. 61938

PHONE: (800) 230-3718
FAX: (800) 677-2706
ANAMETELECTRICAL.COM
CS@ANAMETELECTRICAL.COM